

The RFL4-LED103 is a sleek, ruggedly designed, high efficiency floodlight. This LED flood has multiple mounting options and accessories to suit a wide range of applications.



APPLICATIONS

Ideal for building façades, sign lighting, area lighting, and wall washing in both commercial and industrial applications.

SPECIFICATIONS

Construction

Precision die cast aluminum housing with clear polycarbonate lens. Superior heat sink design with air-flow fins on the top and bottom to maximize fixture life.

LED configuration

Each unit has three high efficiency Chips on Board (COBs) that delivers 11522 lumens. The LEDs have a colour temperature of 5000K as standard. 4000K, 3000K also available. The CRI is greater than 70 and the operating temperature range is -40°C to +40°C.

Beam Distribution

NEMA 6H X 6V (wide) is standard. NEMA 3H X 3V (narrow) is available as an option.

Electrical

Total system wattage of the unit is 101W. The standard unit has a high efficiency driver that operates at 120 - 277V. 347V driver also available as an option.

Mounting

Standard unit is available with three mounting options:
- Yoke mount - 4.53" Yoke with watertight connector.
- Slip Fitter - fits on 2 3/8" tenon and can be bull horn mounted in various configurations.
- Wall mount - complete with a wall bracket.
Please contact us to learn more.

Finish

Standard finish is Bronze. Please consult factory for custom colour.

Accessories

Visor, Polycarbonate lens, Photocell, Wire Guard, Phillips Dynadimmer. Phillips Dynadimmer dims the fixture to 25% for 6 hours instead of operating at 100% at all times.

Project	
Type	
Date	
Notes	

Equivalent to	400W MH
Input Watts	101W
Lumens	11,522
Efficiency	114 lumens per watt

Operating Temperature	-40°C - +40°C
Certification	cULus, DLC, IP65 meets LM79, LM80
Warranty	5 Years
Colour Temperature	5000K (standard) 4000K (option) 3000K (option)
LED life	100,000 hours
Effective Projected Area (EPA Rating)	1.1 sq ft
Total Harmonic Distortion	10%
Power Factor	0.986

DIMENSIONS

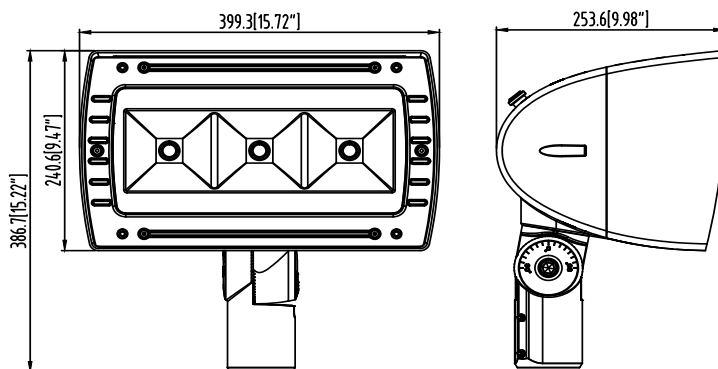

With optional Narrow beam (3X3)



MOUNTING OPTIONS

Slipfitter, Yoke, Wall bracket

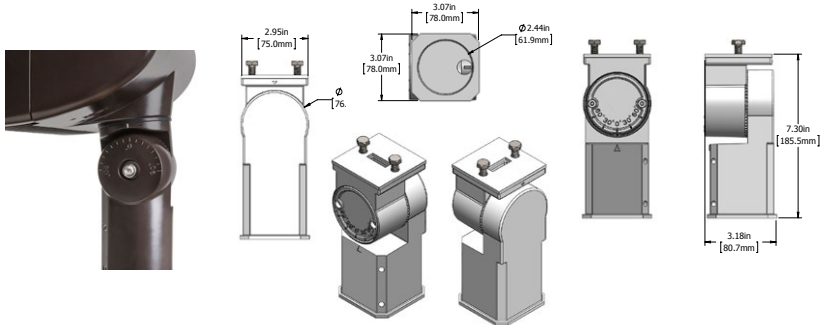

Slipfitter

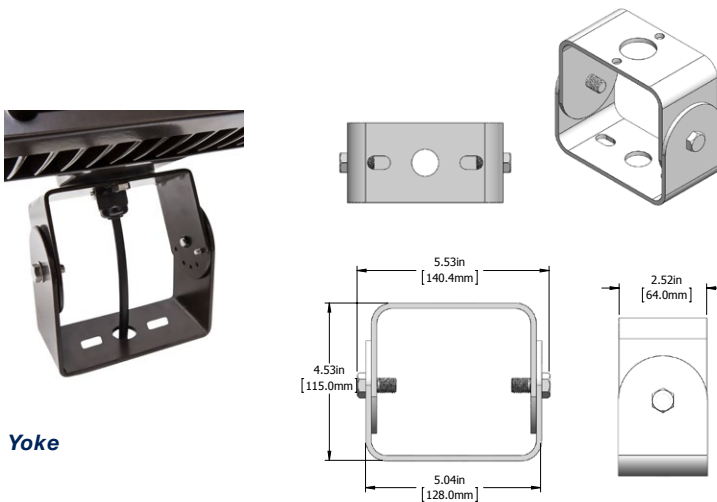

Yoke

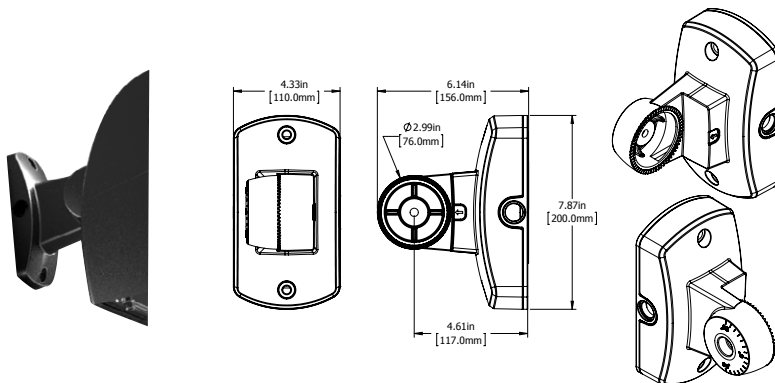

Wall bracket

ACCESSORIES

Polycarbonate lens, Wire guard, Visor

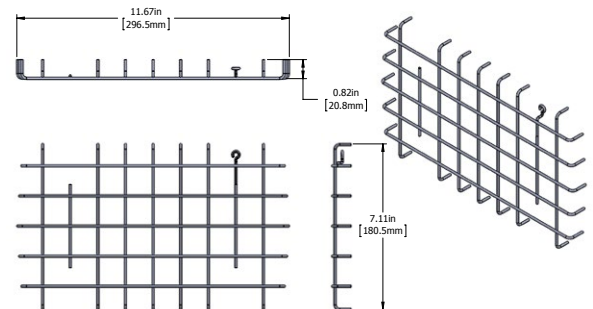

Wire Guard

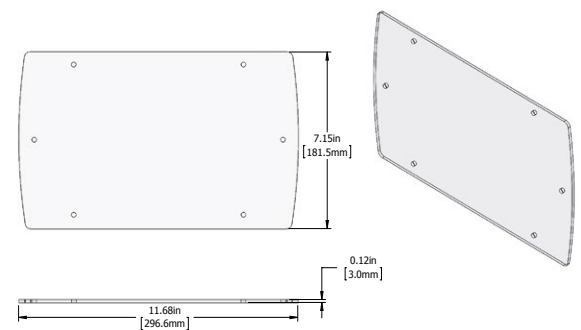

Polycarbonate lens

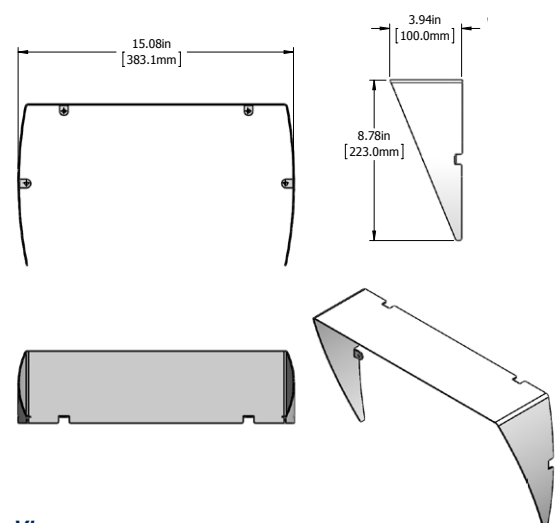

Visor

PHOTOMETRIC DATA

POLE MOUNTING

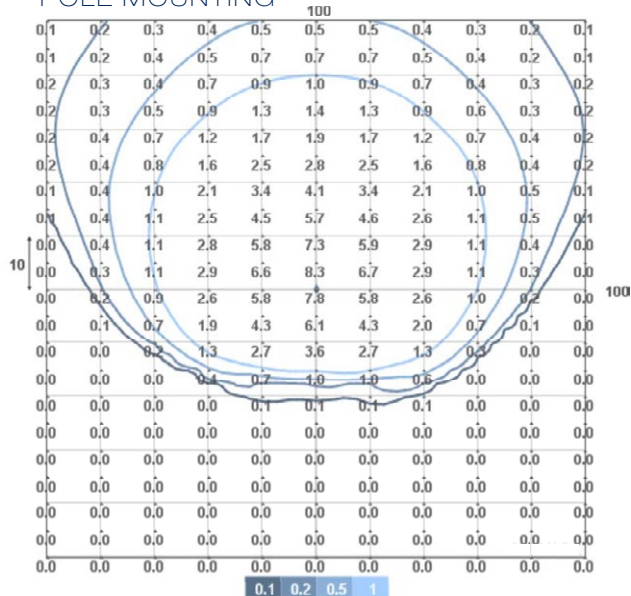

Mounting Height 24 ft
Tilt 20°

WALL WASHING - GROUND LEVEL MOUNTING

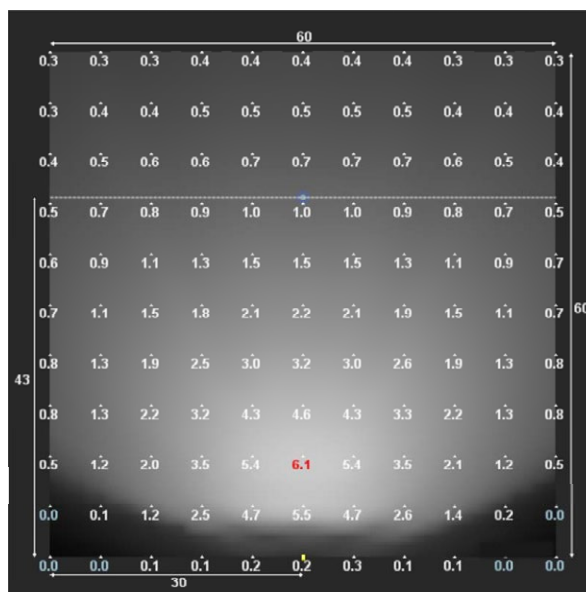

Spacing Results

Spacing 60 ft
Quantity 1
Tilt 155°

Calculation Results

Minimum 0.0 fc
Average 1.3 fc
Maximum 6.1 fc
Ave/Min N/A
Max/Min N/A
Point Spacing 6X6 ft

Design Summary

Wall Width 60 ft
Wall Height 60 ft
Setback from the wall 20 ft

WALL MOUNTING

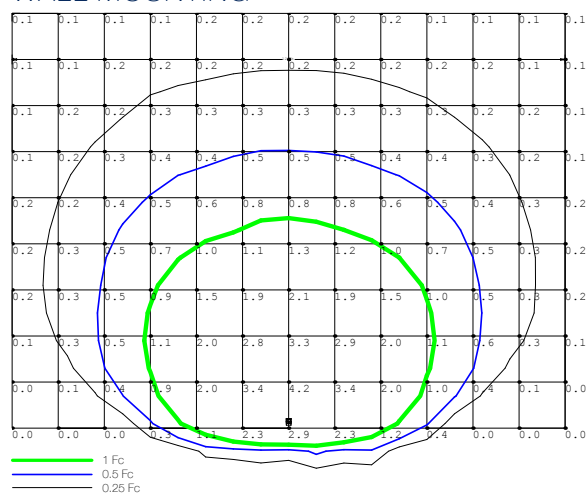

Mounting Height 30 ft
Tilt 45°
10X10 ft grid

ORDERING GUIDE

RFL4	LED103						
VOLTAGE	COLOUR TEMP	BEAM	FINISH	MOUNTING	OPTIONS		
B - 120 - 277V*	5K - 5000K*	W - Wide (6X6)*	BRZ - BRONZE*	YK - Yoke*	V - Visor		
A - 120V	4K - 4000K	N - Narrow (3X3)	CC - CUSTOM	SF - Slipfit*	WG - Wire Guard		
F - 277V	3K - 3000K		COLOUR	WM - Wall Mount*	PCL - Polycarbonate Lens		
C - 347V					PCA - 120V Photocell**		
					PCF - 277V Photocell**		
					PCC - 347V Photocell**		

* Standard configuration

** Chosen photocell option must be the same as voltage