



SMT6H-LED

Summit LED Bollard Series



IDEAL APPLICATIONS

- ✓

Pathways
- ✓

Parkettes
- ✓

Townhouses
- ✓

Landscape Applications
- ✓

Condos

DESCRIPTION:

The Summit Series of Bollards are high performance luminaires in a sleek, modern design. With engineered optics geared towards eliminating glare and meeting DLC LUNA / dark sky requirements, the SMT-LED Series is at the forefront of pathway

FEATURES:

- Aesthetic, slim, modern fixture design.
- 3 heights to choose from; 11", 24", 36".
- Full cut-off design eliminates uplight and light pollution. Optics are hidden from line of sight limiting glare while creating a comfortable experience for passersby.
- Innovative optic design creates even and uniform light distribution across the surface. High performance optics allow for more spacing between bollards reducing the number fixtures needed in an install.
- 2700K, 4000K, 5000K colour temperature options. 2700K CCT meets Dark Sky and DLC LUNA requirements. (DLC LUNA certification in progress).
- Custom paint finishes available.
- Extruded Aluminum shaft, die cast base and polyester powder coat paint finish. Withstand extended outdoor exposure, provide resistance to corrosion, atmospheric agents, UV rays, degradation, and abrasion.
- IP66 rated - Designed to fully protect from dust ingress and against powerful water jets as per international standard.
- IK10 rated - Designed to protect against vandalism and mechanical impacts as per IEC 62262 standard.
- Twist Lock mechanism with stainless set screws for easy installation.
- Set of three zinc plated 8" long 3/8-16" anchor bolt with nuts and washers.

SPECIFICATIONS	SMT6H12-LED10	SMT6H24-LED20	SMT6H36-LED24
Watts	8 W	20 W	25 W
Lumens	840 Lm	2100 Lm	2625 Lm
Efficacy	105 Lm/W		
Voltage	120-277*, 347V		
CCT	2700K, 4000K*, 5000K		
Dimming	1-10V Dimming		
THD	<20%		
Power Factor	0.95	0.98	0.95
Beam Distribution	Type V (360 degree)		
LED Life (L70)	≥ 50,000 hours		
Housing Finish	Bronze*, Custom Colours		
Housing Details	Die Cast Aluminum		
Surge Protection	6kV (inbuilt surge suppressor)		
Height	11"	23.6"	35.4"
Shaft Diameter	5.3"		
Operating Temp.	-40°C to +40°C (-40°F to 104°F)		
Certifications	ETL, Wet Location, IP66, DLC 5.1 , DLC LUNA (In Progress)		

\*Standard Configuration  
Note: 120-277V will be DLC 5.1 and 2700K will meet DLC LUNA requirements.



## DIMENSIONS:

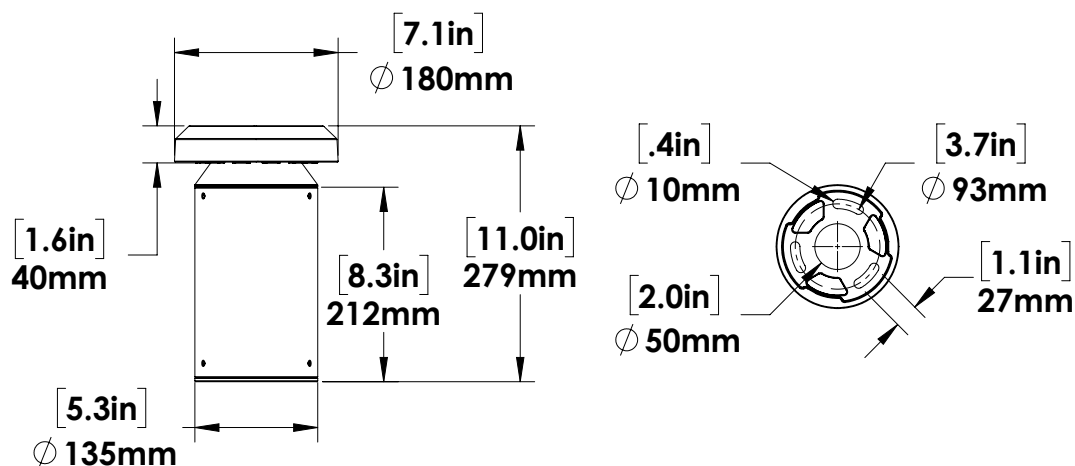

**SMT6H12-LED10**

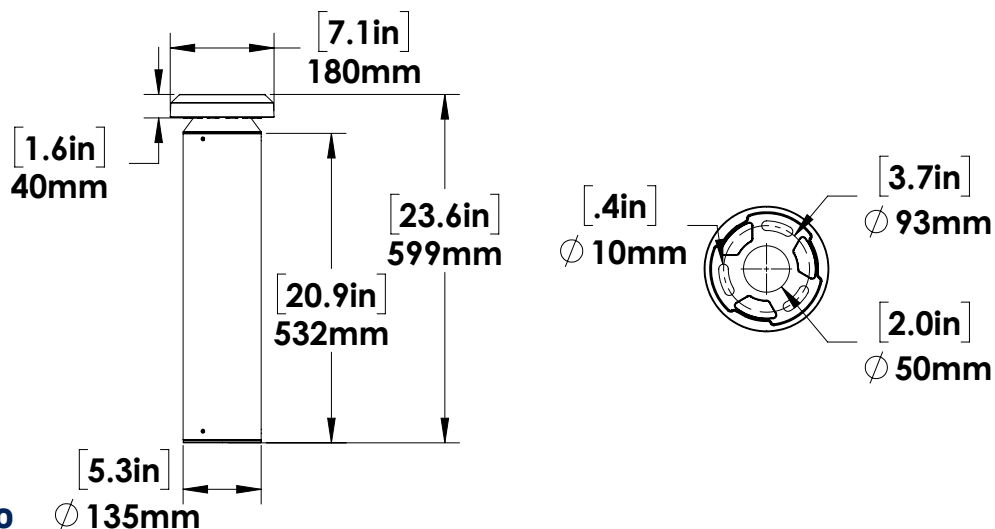

**SMT6H24-LED20**

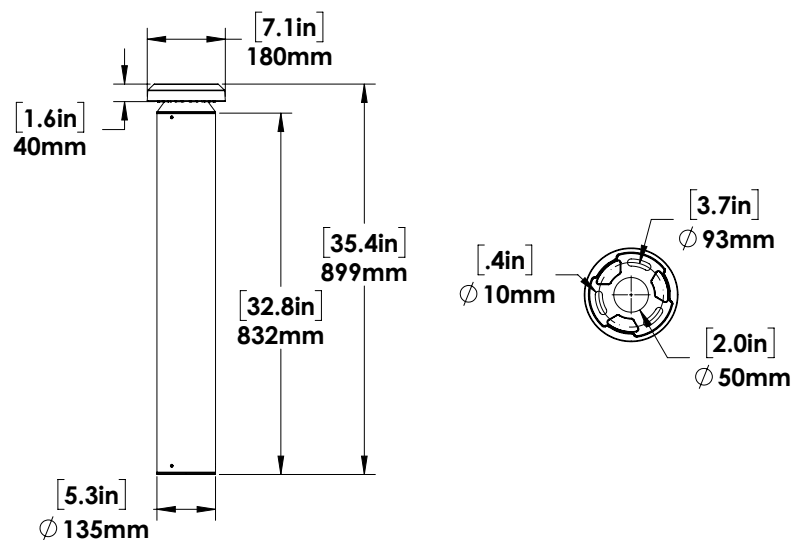

**SMT6H36-LED24**

## AMPERAGE DRAW & SURGE PROTECTION

	CURRENT (A)					SURGE PROTECTION (kV)	
	120V	208V	240V	277V	347V	120-277V	347V
SMT6H-LED10	0.09A	0.06A	0.05A	0.04A	0.04A	6kV	
SMT6H-LED20	0.18A	0.11A	0.09A	0.08A	0.07A		
SMT6H-LED24	0.21A	0.13A	0.11A	0.1A	0.08A		

## BOLLARDS DIAGRAM



1. **Full Cut-off Shielded Design**
- Zero uplight

2. **Optics**
- Designed for wide spread illumination and glare control.
  - Hidden from line of sight.
- Anti Glare Cone Design**
- Eliminates glare above light aperture.

3. **LED Module**
- Options for 5000K, 4000K or 2700K CCT (2700K CCT meets Dark Sky/ DLC LUNA Standards)

4. **Bollard Construction**
- Die Cast Head with Internal heat sink, head has twist lock mechanism secured in place with stainless steel set screws. Extrude aluminum shaft. Both the head and shaft have a polyester powder coat paint finish.

5. **Twist Lock Mechanism**
- Base plate, shaft and head are twist locked.

## ORDERING GUIDE:

				T5	DIM	
Fixture	Wattage	Voltage	Colour Temp.	Optics	Finish	Dimming
SMT6H12	LED10	B - 120-277V*	2.7K-2700K	T5-360 Degree	BRZ - Bronze*	DIM - 1-10V Dimming
SMT6H24	LED20	C - 347V	4K - 4000K*		CC - Custom Colour	
SMT6H36	LED24		5K - 5000K			

\*Standard Configuration

**Note:**

- 3/8-16" anchor bolt set and IP66 cable connector included with product.
- Choose 2700K for DLC LUNA requirements.
- Anchor Bolt Template pattern can be accessed online under Resources.

STOCK CODE	DESCRIPTION
081418	SMT6H12-LED10-B-4K-T5-BRZ-DIM
081467	SMT6H24-LED20-B-4K-T5-BRZ-DIM
081466	SMT6H36-LED24-B-4K-T5-BRZ-DIM