



SL2-LED20

LED Strip Light

SPECIFICATIONS

Watts	20 W
Lumens	2661 lm
Efficacy	138.38 Lm/W
Replaces Up To	2 Lamp T8 17W
Colour Temp**	Selectable - 3K, 4K, 5K
Certification	cULus, IP20
Operating Temp	-30°C to +40°C
Voltage	120-347V
LED Life (L70)	>100,000 hours
Housing Material	Steel
Lens Material	Polycarbonate
Lens Type	Frosted
Mounting	Surface mount, suspended mount using linear ceiling pendant mount kit.
Total Harmonic Distortion	2.6%
Power Factor	0.993
CRI	85
Internal Surge Protection	6KV
Weight	2.8 lbs

**Colour temperature is selectable and can be adjusted on the fixture through a switch. The default switch setting is set to 4K on the fixture.



DESCRIPTION

The SL2-LED20 strip light provides a highly efficient lumen output of approx. 2400 lumens ideal for replacing 2 Lamp T8 17W fixtures. The frosted linear lens provides uniform light distribution ideal for use in shops, coves and general area lighting.

APPLICATIONS



Shops



Cove Lighting



General Area Lighting

FEATURES

- Fixture can be set at a colour temperature of 3000K, 4000K or 5000K while installing through a switch inside the housing
- Narrow, linear design with frosted lens for uniform light distribution
- Join up to 35 fixtures on a single circuit using easy connector steel plates. NOTE: Fixtures are daisy chained with line wires fished through the housing continuous row.
- Options: Dimming high frequency motion sensor, remote control, wire cage, reflector wings, linear ceiling pendant mount kit.
- Optional factory-installed smart lighting control available: Lutron Athena Wireless smart control allows zone and control changes digitally and wirelessly.

DIMENSIONS

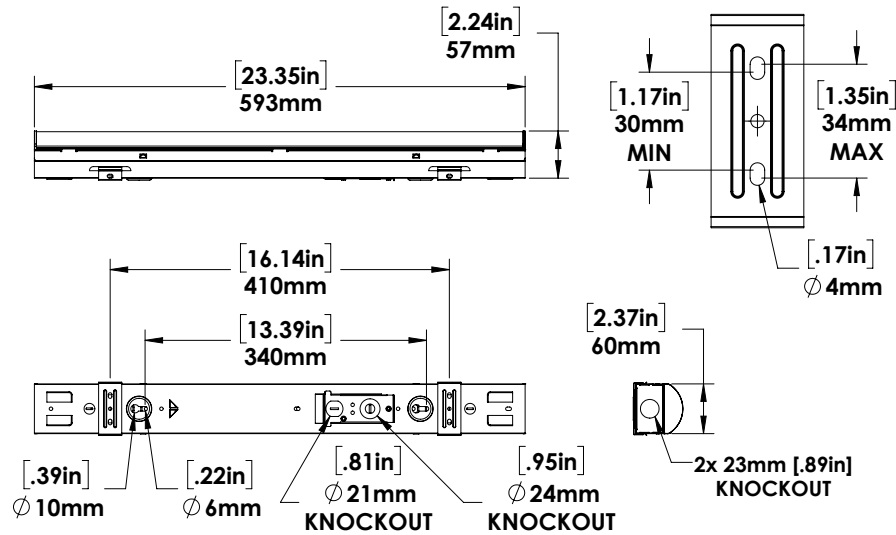

Keyholes for
suspended/ceiling
mounting

COLOUR SELECTABLE SWITCH

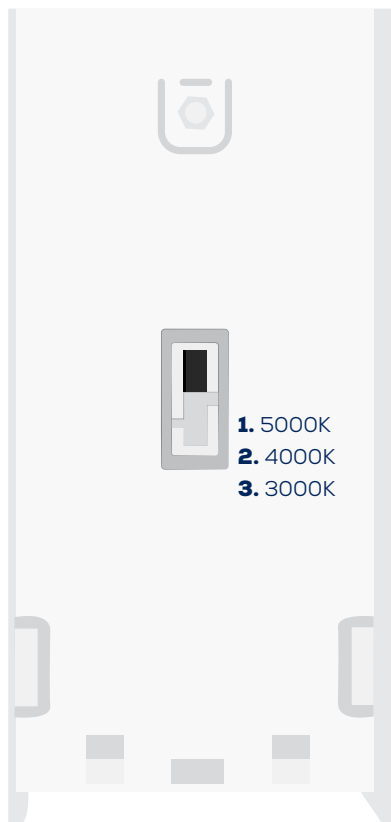

1. 5000K
2. 4000K
3. 3000K

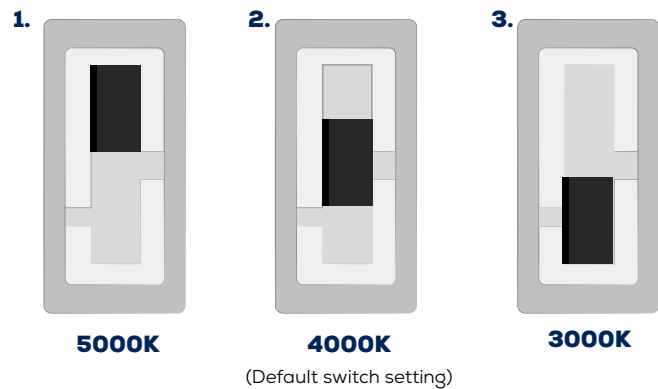

Easily change the colour temperature with the flip of a switch.

1. TOP position = 5000K
2. MIDDLE position = 4000K
3. BOTTOM position = 3000K

The switch is located
inside of the fixture.

LINEAR CEILING PENDANT MOUNT KIT

Linear Ceiling Pendant Mount Kit

Contains 2 x 5 foot aircraft cables with ceiling mounting plates, fixture mounting rod and nut, 6 drywall anchors, and 6 screws.

SKU 089814



REFLECTOR WINGS

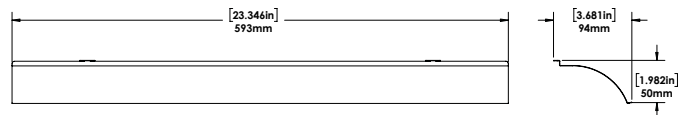

Reflector Wings Kit - Wings attach by inserting tabs into the cutouts on the fixture
SKU 099560

WIRE CAGE

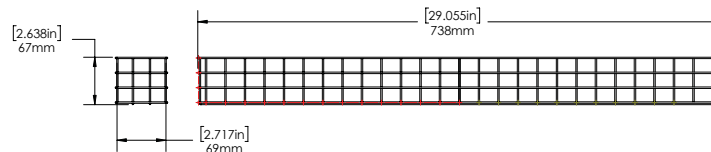

Wire Cage - To install, place wire cage over the fixture and screw the clips on to the mounting surface.
SKU 002270

MOTION SENSOR SPECIFICATIONS	
POWER SUPPLY	12V-24VDC*
HIGH FREQUENCY SYSTEM	5.8GHZ +/-75MHZ (HIGH FREQUENCY MICROWAVE OUTPUT)
DIM CONTROL OUTPUT	0-10V, MAX. 25MA SINKING CURRENT
DETECTION RADIUS/ANGLE	MAX 8M (26FT) AT 360°
MOUNTING HEIGHT	MAX 3.6M (12FT)
REMOTE CONTROL RANGE	MAX 15M (50FT)
HUMIDITY	MAX 95% RELATIVE HUMIDITY
OPERATING TEMP.	-40°C TO 70°C (MOTION SENSOR) 0°C TO 50°C (REMOTE CONTROL)
INSTALLATION	FACTORY INSTALLED
PROGRAMMING	USING DIP SWITCHES ON SENSOR OR USING RC-100 REMOTE (SOLD SEPARATELY)

*12VDC AUX AVAILABLE FROM THE LED DRIVER- CAN BE USED FOR MOTION SENSOR AND OTHER LIGHTING CONTROLS.

DEFAULT MOTION SENSOR SETTINGS					
BRIGHTNESS	SENSITIVITY	HOLD TIME	DAYLIGHT SENSOR	STAND-BY DIM	STAND-BY TIME
100%	100%	10 seconds	Disabled	DIM: 30%	60 minutes

ONCE POWERING THE LIGHT FIXTURE, THE MOTION SENSOR WILL USE THE FOLLOWING DEFAULT PARAMETERS TO OPERATE.

MOTION SENSOR COVERAGE

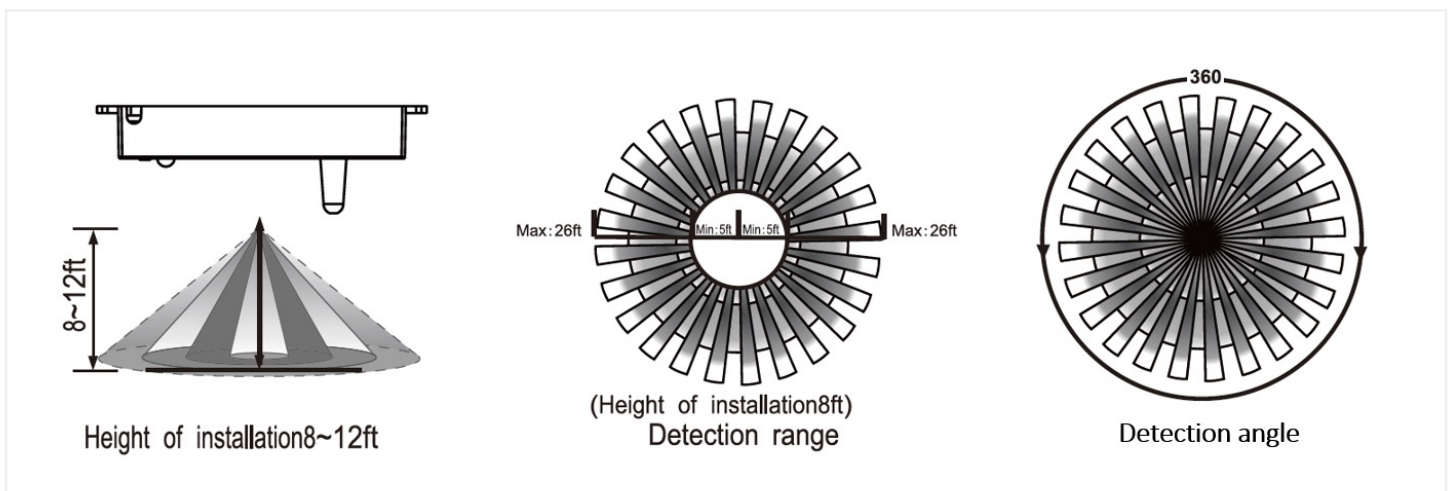

ADJUSTING MOTION SENSOR SETTINGS USING DIP SWITCHES

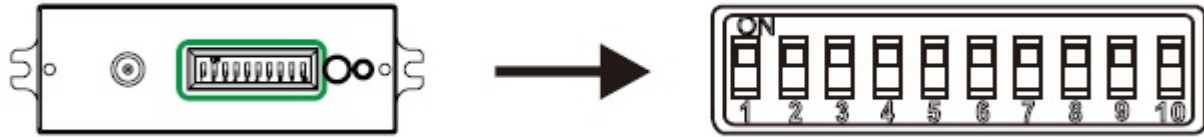

ADJUSTING MOTION SENSOR SETTINGS USING RC-100 REMOTE

TECHNICAL SPECIFICATIONS	
<p>The diagram shows the RC-100 remote control with the following buttons and functions:</p> <ul style="list-style-type: none"> BRIGHTNESS: 70%, 80%, 90%, 100% SENSITIVITY: 20%, 50%, 75%, 100% HOLD TIME: 10s, 1m, 5m, 10m, 15m, 20m, 30m, 60m DAYLIGHT SENSOR: 10, 30, 50, 100, 300, 500 STAND-BY DIM: 0%, 10%, 30%, 50%, +∞, 1m, 30m, 60m ON/OFF, DISP, SEND, AUTO, OK, RESET, TEST 2s, MODE1, MODE2, MODE3, MODE4 	<p>BRIGHTNESS: Sets the highest light fixture brightness when motion is detected.</p>
	<p>SENSITIVITY: Sets the sensitivity to which the sensor will detect motion. It describes the radii of the circular detection zone.</p>
	<p>HOLD TIME: The time the light fixture will remain at the brightness setting after it detects motion.</p>
	<p>DAYLIGHT SENSOR: The lux setting that the light fixture will turn on/off. If the ambient lux is more than the defined lux setting, the fixture & sensor function will turn off and remain off until the ambient lux is below the setting. To disable the lux sensor, select the SUN icon. To set the lux to match current room conditions, select the EYE icon.</p>
	<p>STAND-BY DIM: The Dim level that the light fixture will dim down after the Hold Time has expired.</p>
	<p>To disable dimming and only have ON/OFF, select the 0% icon.</p>
	<p>STAND-BY TIME: The time the light fixture will remain in the dim down state before it shuts off.</p>
	<p>To disable the light from shutting off, select the INFINITY icon.</p>

NOTE: DETAILED PROGRAMMING INSTRUCTIONS AVAILABLE FOR DIP SWITCHES AND RC-100 REMOTE IN MOTION SENSOR & REMOTE CONTROL MANUAL.

SL2-LED20-B-4K-DIM(SL2-LED20-B-VK-DIM MOUNTED AT 8 FEET

Total Lumens = 2448

Mounting Height = 8 Ft

Maximum Calculated Value = 11.55 Fc

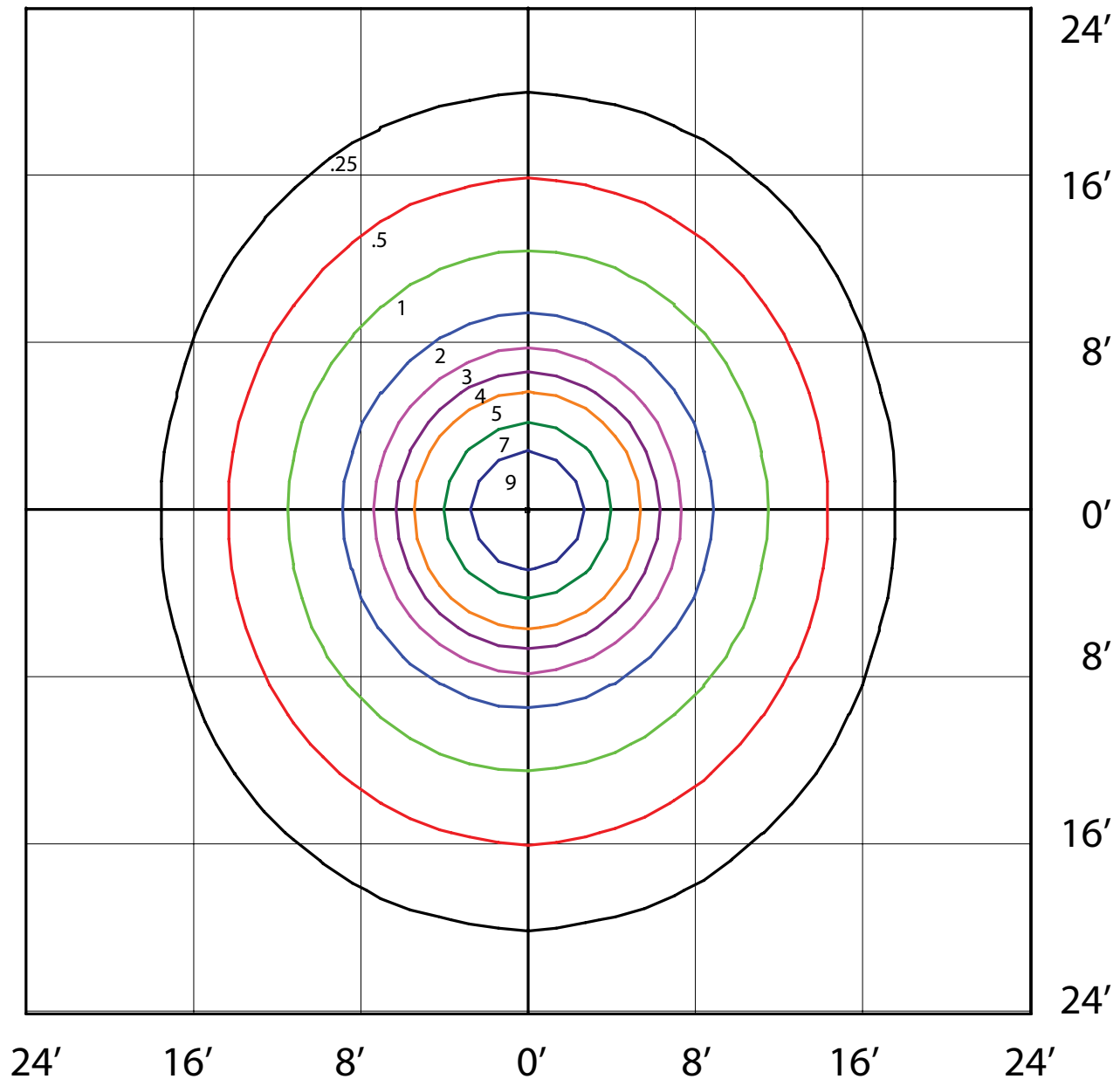

ORDERING GUIDE

SL2	LED20	H	VK	DIM	
WATTS	VOLTAGE	COLOUR TEMP.	DRIVER	CONTROLS	
	H - 120-347V*	VK - Colour Selectable (can be adjusted to 3K, 4K, or 5K)	DIM - 0-10V Dimming*	BLANK - No Controls*	
				DHFS - Dimming High Frequency Sensor (factory installed inside the housing)	
				AWN - LUTRON SMART CONTROL**	

*Standard Configuration.

**Factory installed Lutron Athena Wireless Node with RF only (A-WN-D01-RF-WH). Gateway and controller not included.

FIELD INSTALLED ACCESSORIES

CHECK THE ACCESSORIES YOU WISH TO ORDER:

- 089814 LINEAR CEILING PENDANT MOUNT KIT
- 002270 SL2-LED WIRE CAGE
- 099560 SL2-LED REFLECTOR WINGS KIT - WHT
- 087016 RC-100 MOTION SENSOR REMOTE CONTROL