



# SLE Strip Light

Bright Ideas Simplified  
Into One Universal SKU



Wherever you need reliable, high-performance lighting, the SLE is your go-to solution.

- ✓ Sleek toolless opening design.
- ✓ High lumen version (4ft: 7,000 LMs, 8ft: 12,400 LMs).
- ✓ Externally adjustable CCT and wattage switches.
- ✓ Available in 3 different lengths 2ft, 4ft, and 8ft; with and without motion sensor.
- ✓ Remote control DHFS option.
- ✓ All sizes available with optional field-installed Bluetooth PIR sensor; compatible with ControlledLED.



Adjustable  
Lumens



Selectable  
Colour Temperature



Motion Sensor  
and Bluetooth



DLC  
Premium

## Now with **CONTROLLED**

Harnessing the power of Bluetooth Mesh technology, **ControlLED by RAB DESIGN** enables the seamless control of lighting fixtures, meeting your lighting control needs how you want them, when you need them.



# Innovative New Design Makes Installation Quick and Painless

Three convenient sizes for you to choose from; 2ft, 4ft, and 8ft.

Accessible CCT switch and wattage switch

7x 1/2" conduit openings

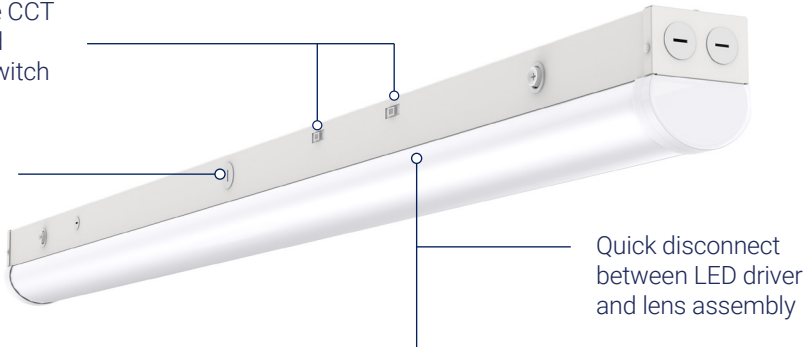

Compatible with junction Box for Bluetooth PIR sensor.

Tool-less press clip for easy release of lens & LED board assembly



Aircraft cables keep the lens assembly hanging in place during installation and maintenance.

## Optional accessories to ensure every job can be completed timely and every fixture delivers its end goal.



**Junction Box** with Bluetooth PIR sensor to enable ControlledLED.



**Junction Box Cover** is standard inclusion in every box; helps seal while maintaining quick and easy access to junction box.



**DHFS** Dimming High-Frequency Motion Sensor.



**Wire Guard** to help protect the fixture from debris, foreign object impact, and tampering.

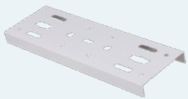

**Connecting Plate** to connect multiple fixtures together.



**Reflector Wings** allow the light to be controlled and reflected into specific areas as desired.



**Suspension Kit** including safety hooks to allow for a range of installation hanging heights.



**8W Battery Back-up** (factory installed).



**Engineered by skilled hands,  
for skilled hands.**

© RAB Design Lighting Inc. 2025. All rights reserved.  
For more information, visit [rabdesign.ca](http://rabdesign.ca) or email [salesupport@rabdesign.ca](mailto:salesupport@rabdesign.ca)