



RD-L8

Linear Adjustable Sign / Facade Light

RAB Design's RD-L8 is a **sturdy, sleek design, and high performance** sign light suitable for any wall washing applications. The fixture is designed to be rotated 360° allowing light to be directed in any direction. The RD-L8 is a highly versatile sign light available in lengths of 2', 4', 6' and 8' that can be combined to form a continuous run. Both wall mount and parapet mounting options are available to suite a wide variety of sign and wall lighting applications.



FEATURES

- Rugged extruded aluminum heat-sink construction to withstand weather conditions.
- Clear downlight lens and translucent casing encapsulating the aluminum extrusion can be rotated 360° to direct light in any direction.
- High quality LEDs are used to provide even illumination and maintain brightness in cold weather conditions.
- Standard wall mount option or parapet mount is available.
- The wall mount standard aluminum arms extend 18" from the wall; custom arm lengths are available upon request. Two aluminum die cast mounting discs with hardware are provided for ease of installation to the wall.
- The parapet mount has one steel arm with a steel driver box, and depending on the single or dual configuration, one or two aluminum arms with an aluminum mounting plate.
- The standard finish of the heat-sink is natural aluminum in PC housing.
- Each fixture uses its own high efficiency dimmable driver as the power supply.
- Continuous run applications are available - please consult Customer Service.



INSTALLATION IMAGES



Wall mount - single fixture



Parapet mount (+ top view) - three single fixtures



Dual configurations (same or different lengths can be combined)

IDEAL APPLICATIONS



Sign Lighting



Wall Washing

SPECIFICATIONS

| PERFORMANCE | |
|--|--|
| Lumens | 1070 lm/foot |
| Efficacy | 97 lm/W |
| CCT | 3000K, 4000K, 5000K |
| LED Lifetime (L70) | 100,000 Hrs |
| CRI | ≥ 80 |
| ELECTRICAL | |
| Watts | 11 W/foot |
| Voltage | 120-277V, 347V |
| Dimming | 0-10 V |
| Power Factor | 0.98 |
| THD | < 20% |
| CONSTRUCTION | |
| Heat-sink | Aluminum extrusion encapsulated in coextruded polycarbonate sleeve |
| Lens | Clear Polycarbonate |
| Wall Mount Arms | Aluminum, powder coated Sparkle Silver |
| Parapet Mount Arms | One aluminum arm and one steel arm Powder coated Sparkle Silver |
| Heat-sink Finish | Natural Aluminum |
| Operating Temperature | -40°C to 40°C |
| CERTIFICATIONS | |
| cULus Listed for Canada and USA, per UL 2108, CSA C22.2 No. 250.0 Wet Location | |

ORDERING GUIDE

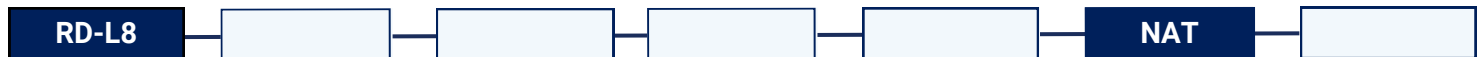

| Model | Configuration | Wattage | Voltage | Colour Temp. | Finish | Mounting |
|-------|---------------|---------|---------------|--------------|--------------------------------------|------------------------|
| RD-L8 | 1X2 | LED20 | B - 120-277V* | 3K - 3000K | NAT - Natural Aluminum in PC housing | Blank - Wall mount* |
| | 1X4 | LED40 | C - 347V | 4K - 4000K* | | PPET - Parapet mount** |
| | 1X6 | LED60 | | | | |
| | 1X8 | LED80 | | | | |
| | <hr/> | | | | | |
| | 2X2 | LED40 | | | | |
| | 2X4 | LED80 | | | | |
| | 2X6 | LED120 | | | | |
| | 2X8 | LED160 | | | | |
| | <hr/> | | | | | |
| | 2+4 | LED60 | | | | |
| | 2+6 | LED80 | | | | |
| | 2+8 | LED100 | | | | |
| | 4+6 | LED100 | | | | |
| 4+8 | LED120 | | | | | |
| 6+8 | LED140 | | | | | |

*Standard configuration.

**Custom arm lengths are available upon request, please reach out to Customer Success for a quote.

In the Configuration column of the Ordering Guide:

When "1X" is being used, it represents a single mount fixture, either wall mount or parapet.

When "2X" is being used, it represents a combination of two identical fixture lengths, either wall mount or parapet.

For example: 2X6 represents 2 sections of 6' fixtures combined together

When "+" is being used, it represents a combination of two different fixture lengths, either wall mount or parapet.

For example: 4+6 represents a 4' fixture combined with a 6' fixture

For more details, please refer to dimensional drawings.

DIMENSIONS

Single Wall Mount:

| RD-L8 CONFIGURATION | A |
|---------------------|-------|
| RD-L8-1X2-LED20 | 26.5" |
| RD-L8-1X4-LED40 | 49.5" |
| RD-L8-1X6-LED60 | 72.6" |
| RD-L8-1X8-LED80 | 95.6" |

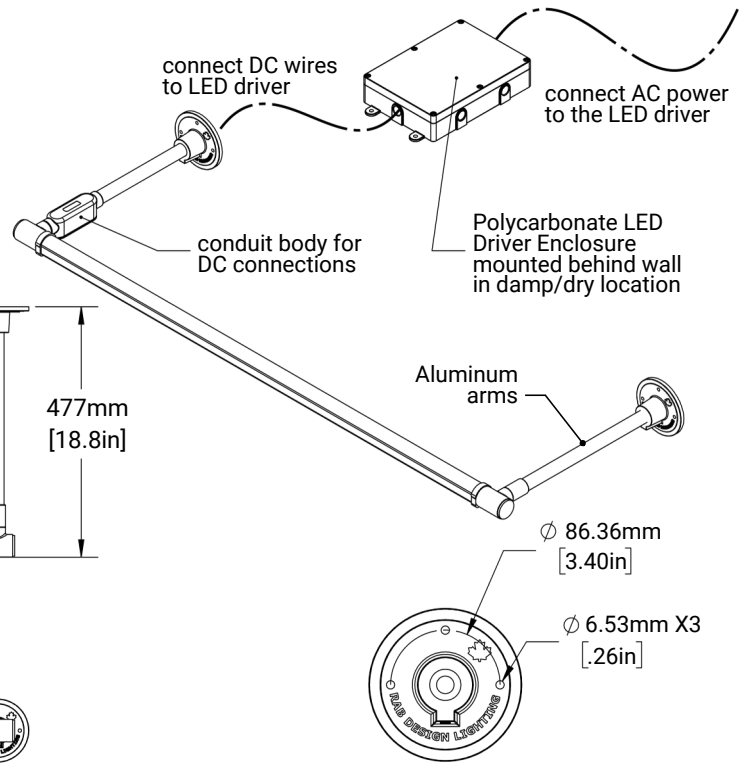
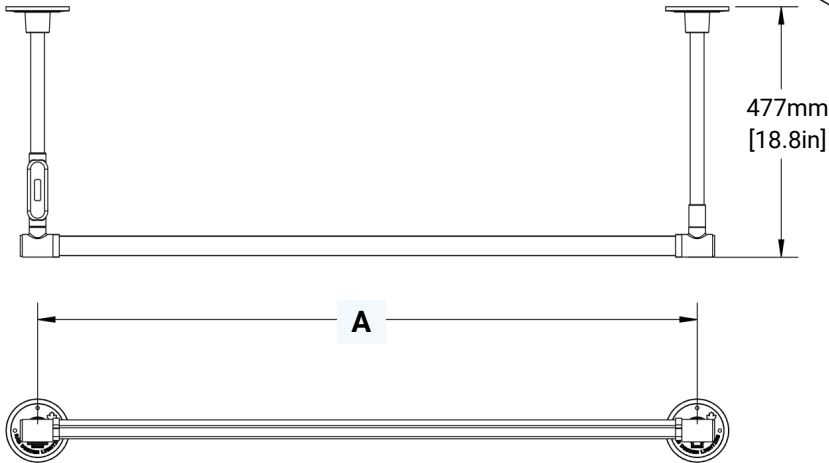

Dual Wall Mount:

| RD-L8 CONFIGURATION | A | B |
|---------------------|-------|-------|
| RD-L8-2X2-LED40 | 26.5" | 26.5" |
| RD-L8-2X4-LED80 | 49.5" | 49.5" |
| RD-L8-2X6-LED120 | 72.6" | 72.6" |
| RD-L8-2X8-LED160 | 95.6" | 95.6" |
| RD-L8-2+4-LED60 | 26.5" | 49.5" |
| RD-L8-2+6-LED80 | 26.5" | 72.6" |
| RD-L8-2+8-LED100 | 26.5" | 95.6" |
| RD-L8-4+6-LED100 | 49.5" | 72.6" |
| RD-L8-4+8-LED120 | 49.5" | 95.6" |
| RD-L8-6+8-LED140 | 72.6" | 95.6" |

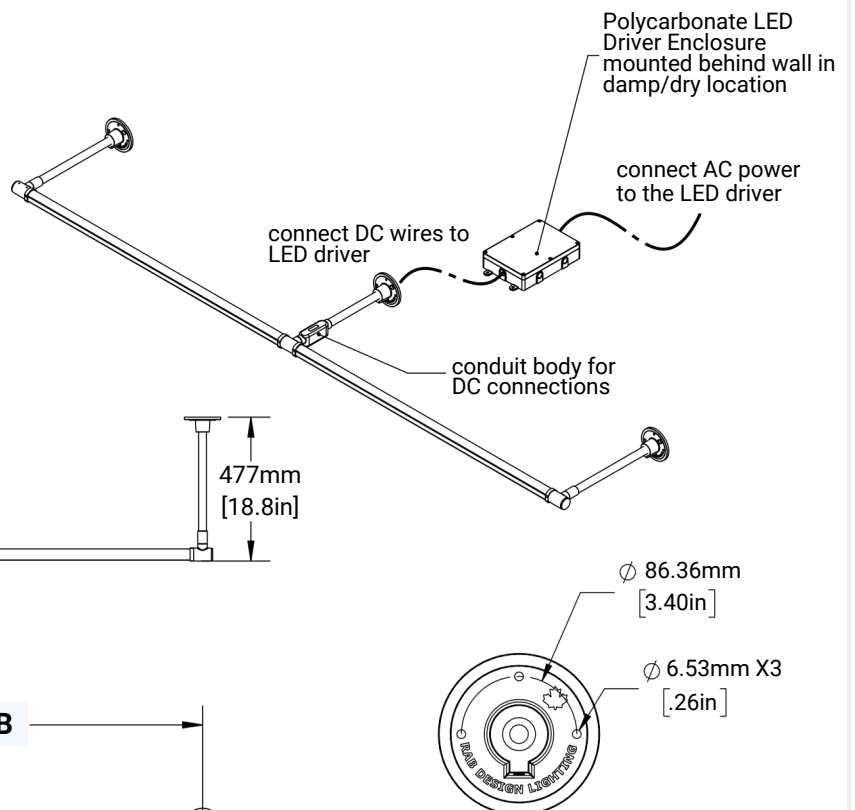
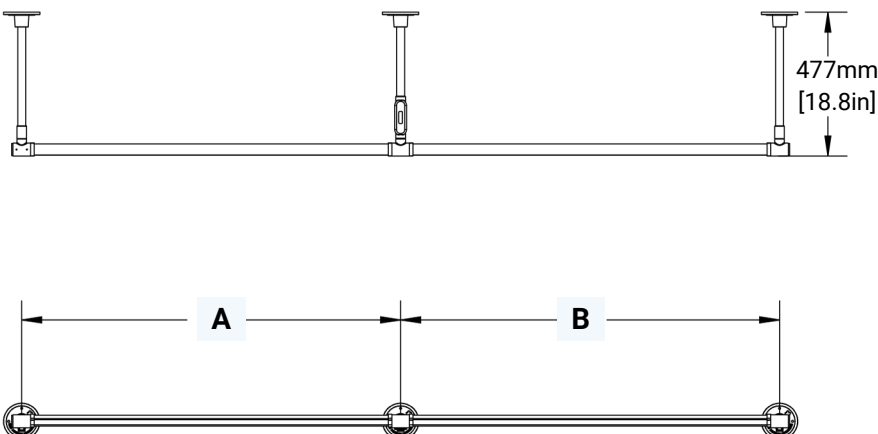

Wall Mount LED Driver Enclosure:

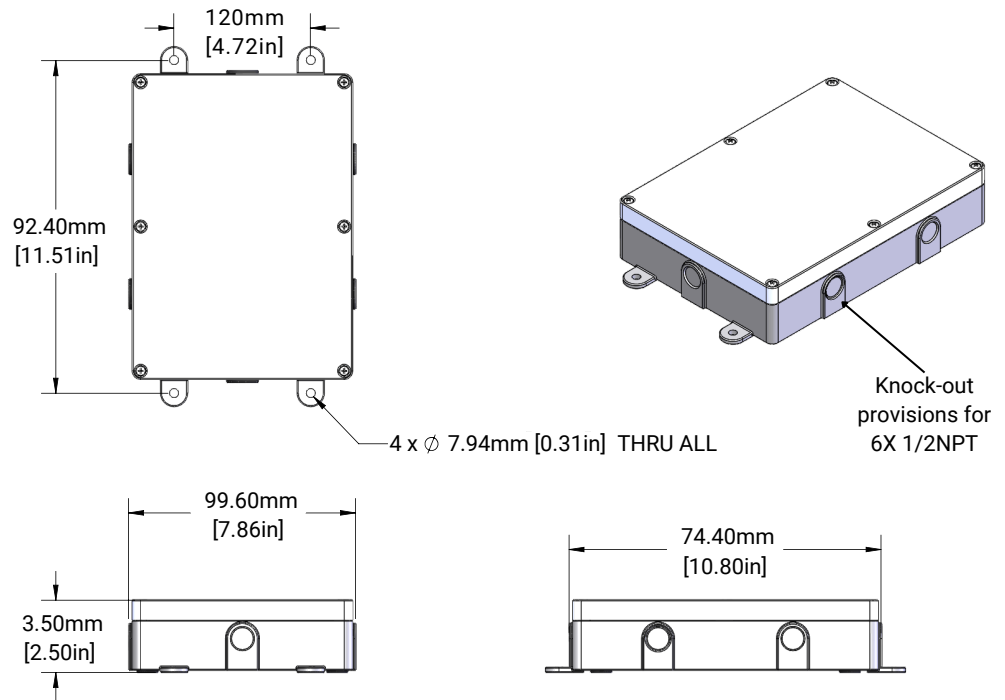

Single Parapet Mount:

| RD-L8 CONFIGURATION | A |
|----------------------|-------|
| RD-L8-1X2-LED20-PPET | 26.5" |
| RD-L8-1X4-LED40-PPET | 49.5" |
| RD-L8-1X6-LED60-PPET | 72.6" |
| RD-L8-1X8-LED80-PPET | 95.6" |

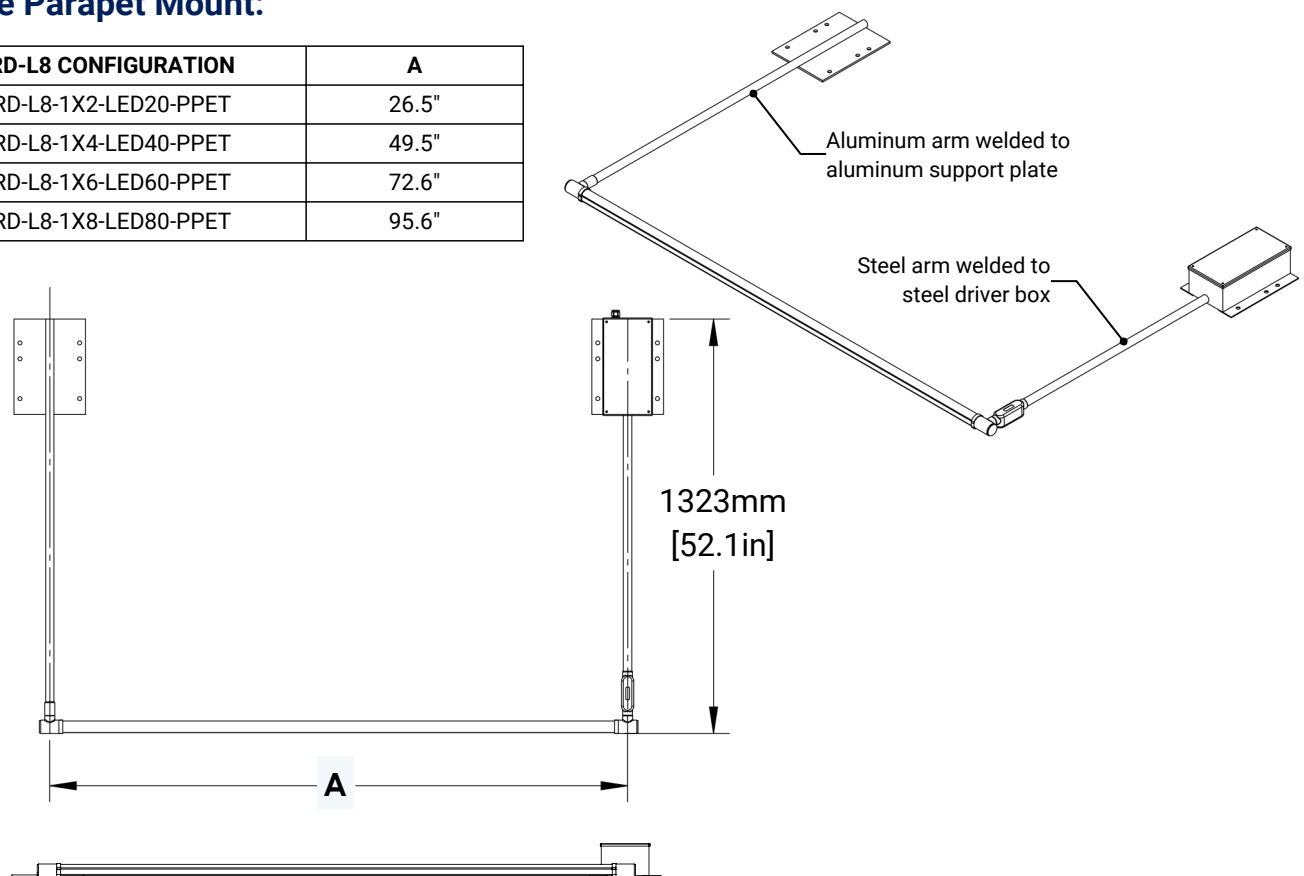

Dual Parapet Mount:

| RD-L8 CONFIGURATION | A | B |
|-----------------------|-------|-------|
| RD-L8-2X2-LED40-PPET | 26.5" | 26.5" |
| RD-L8-2X4-LED80-PPET | 49.5" | 49.5" |
| RD-L8-2X6-LED120-PPET | 72.6" | 72.6" |
| RD-L8-2X8-LED160-PPET | 95.6" | 95.6" |
| RD-L8-2+4-LED60-PPET | 26.5" | 49.5" |
| RD-L8-2+6-LED80-PPET | 26.5" | 72.6" |
| RD-L8-2+8-LED100-PPET | 26.5" | 95.6" |
| RD-L8-4+6-LED100-PPET | 49.5" | 72.6" |
| RD-L8-4+8-LED120-PPET | 49.5" | 95.6" |
| RD-L8-6+8-LED140-PPET | 72.6" | 95.6" |

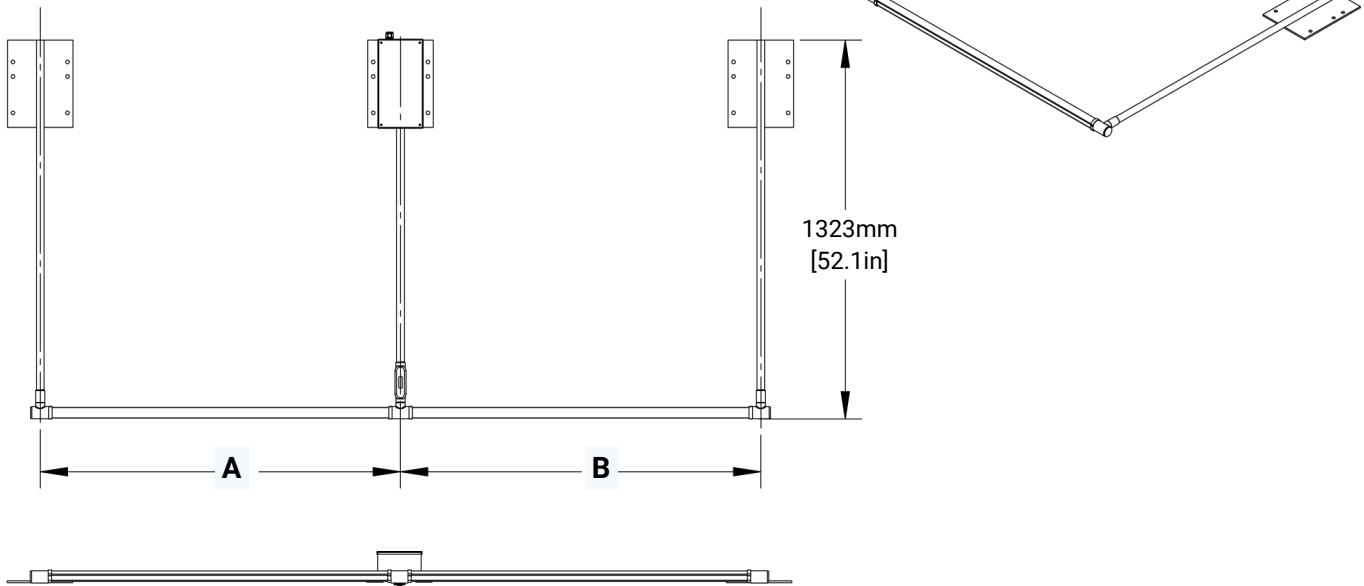

Parapet LED Driver Enclosure: (Steel)

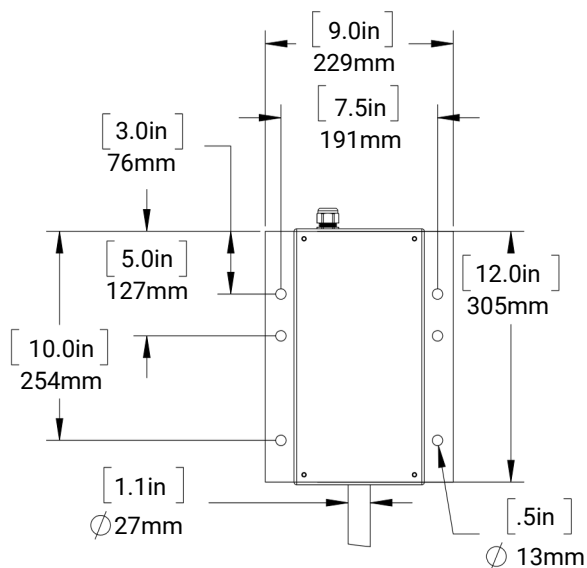

Parapet Roof Mount: (Aluminum)

