

## RD-L8 Installation Instruction - Wall Mount

**Installation should only be performed by a qualified electrician in accordance with the Canadian Electrical code and relevant local codes.**

### Fixture Installation

1. Ensure power is off before wiring
2. Drill holes in wall and secure powered side first. Use appropriate fasteners for the surface.
3. Ensure wall bracket is sealed to wall and/or junction box
4. Attach RD-L8 fixture to arm and wall bracket
5. Position 2<sup>nd</sup> arm onto opposite end of RD-L8 fixture
6. Note: 2<sup>nd</sup> fixture can be powered from same or 2<sup>nd</sup> power supply in same enclosure
7. Secure wall bracket for 2<sup>nd</sup> arm to wall
8. Repeat for additional lengths of RD-L8

Note: The wall bracket is the cover of any certified junction box. The junction box can be surfaced mount or recessed into the wall

### Power supply installation

1. Open power supply enclosure by removing screws on cover
2. Secure power supply enclosure to surface with appropriate fasteners
3. Power supply enclosure will have one or two power supplies. NOTE: each fixture is run on a dedicated power supply.
4. Use liquid tight flex conduit to run VDC wires from power supply to fixture, and to connect power supply to VAC mains.

Note: Power supply enclosure to be installed in dry/damp location (e.g. electrical room)

## RD-L8 Installation Instructions - Wall Mount

### Step 1



Securely attach first wall bracket.  
NOTE: install "powered" wall bracket first

Drill hole through wall to run VDC power cable

### Step 2

Attach powered end of fixture. VDC RED, WHITE and GROUND wires should be in LB connector



Set screws and LB cover should be face down

### Step 3



Attach, 2<sup>nd</sup> end and secure wall bracket to the wall.

## RD-L8 Installation Instructions - Wall Mount

### Step 4

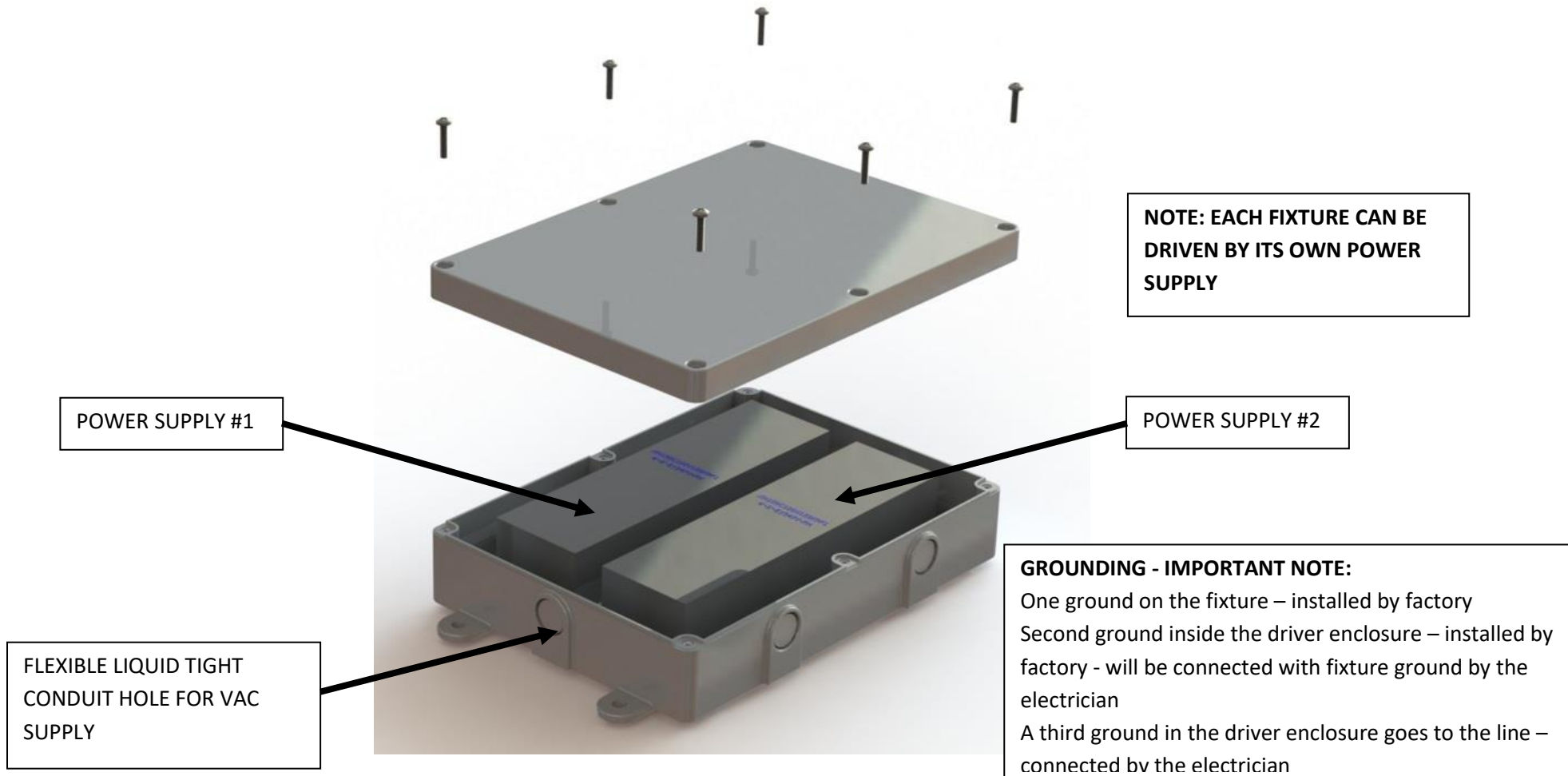

*Revision I*

## RD-L8 Installation Instructions - Wall Mount

### Step 4

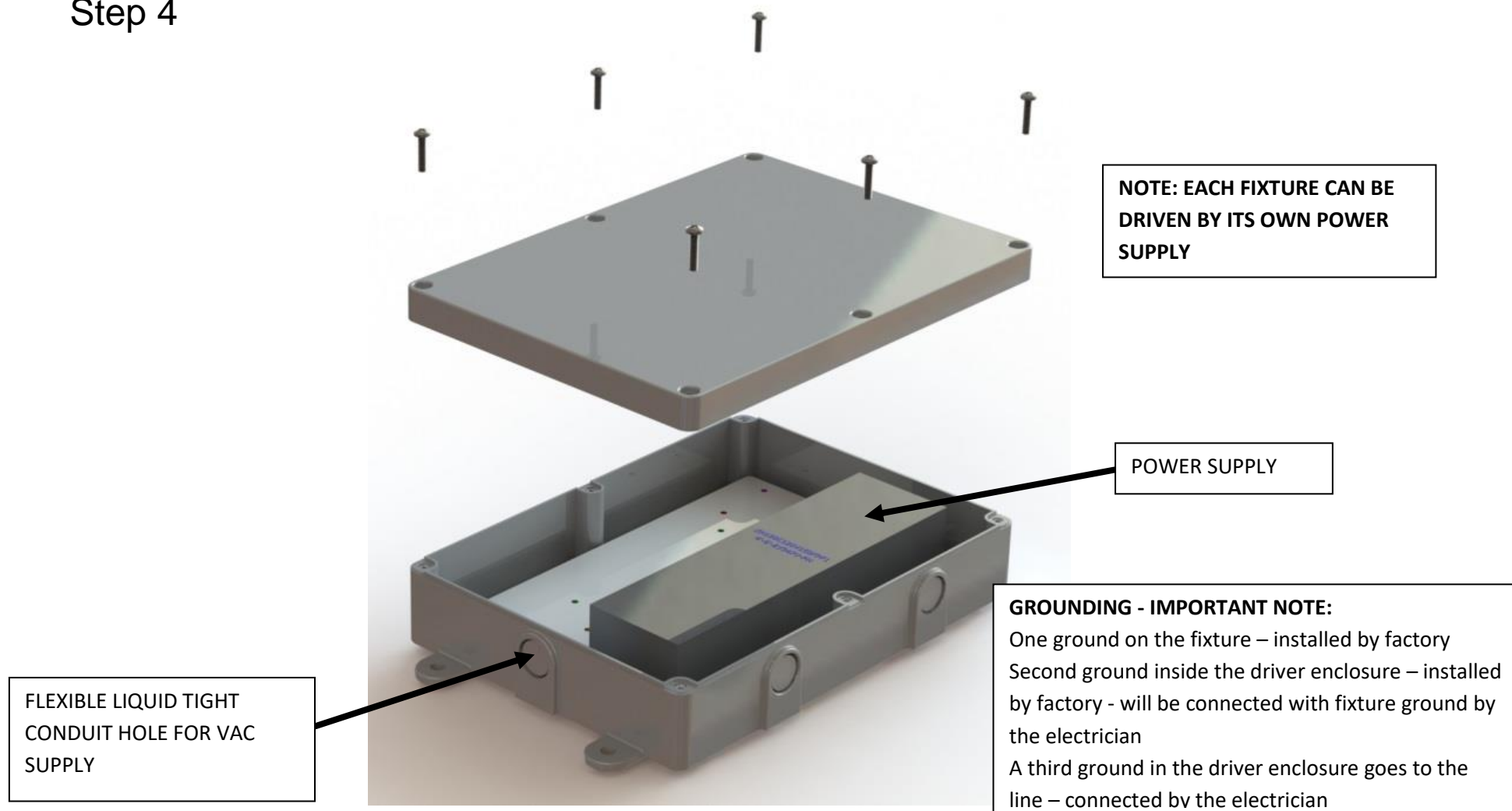

*Revision I*