



FEATURES

- Rugged extruded aluminum heat-sink construction to withstand weather conditions.
- Clear downlight lens and translucent casing encapsulating the aluminum extrusion can be rotated 360° to direct light in any direction.
- High quality LEDs are used to provide even illumination and maintain brightness in cold weather conditions.
- Standard wall mount option or parapet mount is available.
- The wall mount standard aluminum arms extend 18" from the wall; custom arm lengths are available upon request. Two aluminum die cast mounting discs with hardware are provided for ease of installation to the wall.
- The parapet mount has one steel arm with a steel driver box, and depending on the single or dual configuration, one or two aluminum arms with an aluminum mounting plate.
- The standard finish of the heat-sink is natural aluminum in PC housing.
- Each fixture uses its own high efficiency dimmable driver as the power supply.
- Continuous run applications are available - please consult Customer Service.



INSTALLATION IMAGES



Wall mount - single fixture



Parapet mount (+ top view) - three single fixtures



Dual configurations (same or different lengths can be combined)

RD-L8

Linear Adjustable Sign / Facade Light

RAB Design's RD-L8 is a **sturdy, sleek design, and high performance** sign light suitable for any wall washing applications. The fixture is designed to be rotated 360° allowing light to be directed in any direction. The RD-L8 is a highly versatile sign light available in lengths of 2', 4', 6' and 8' that can be combined to form a continuous run. Both wall mount and parapet mounting options are available to suite a wide variety of sign and wall lighting applications.

IDEAL APPLICATIONS



Sign Lighting



Wall Washing

SPECIFICATIONS

PERFORMANCE	
Lumens	1070 lm/foot
Efficacy	97 lm/W
CCT	3000K, 4000K, 5000K
LED Lifetime (L70)	100,000 Hrs
CRI	≥ 80
ELECTRICAL	
Watts	11 W/foot
Voltage	120-277V, 347V
Dimming	0-10 V
Power Factor	0.98
THD	< 20%
CONSTRUCTION	
Heat-sink	Aluminum extrusion encapsulated in coextruded polycarbonate sleeve
Lens	Clear Polycarbonate
Wall Mount Arms	Aluminum, powder coated Sparkle Silver
Parapet Mount Arms	One aluminum arm and one steel arm Powder coated Sparkle Silver
Heat-sink Finish	Natural Aluminum
Operating Temperature	-40°C to 40°C
CERTIFICATIONS	
cULus Listed for Canada and USA, per UL 2108, CSA C22.2 No. 250.0 Wet Location	

ORDERING GUIDE



Model	Configuration	Wattage	Voltage	Colour Temp.	Finish	Mounting
RD-L8	1X2	LED20	B - 120-277V*	3K - 3000K	NAT - Natural Aluminum in PC housing	Blank - Wall mount*
	1X4	LED40	C - 347V	4K - 4000K*		
	1X6	LED60		5K - 5000K		PPET - Parapet mount**
	1X8	LED80				
	<hr/>					
	2X2	LED40				
	2X4	LED80				
	2X6	LED120				
	2X8	LED160				
	<hr/>					
	2+4	LED60				
	2+6	LED80				
	2+8	LED100				
	4+6	LED100				
4+8	LED120					
6+8	LED140					

*Standard configuration.

**Custom arm lengths are available upon request, please reach out to Customer Success for a quote.

In the Configuration column of the Ordering Guide:

When “1X” is being used, it represents a single mount fixture, either wall mount or parapet.

When “2X” is being used, it represents a combination of two identical fixture lengths, either wall mount or parapet.

For example: 2X6 represents 2 sections of 6' fixtures combined together

When “+” is being used, it represents a combination of two different fixture lengths, either wall mount or parapet.

For example: 4+6 represents a 4' fixture combined with a 6' fixture

For more details, please refer to dimensional drawings.

DIMENSIONS

Single Wall Mount:

RD-L8 CONFIGURATION	A
RD-L8-1X2-LED20	26.5"
RD-L8-1X4-LED40	49.5"
RD-L8-1X6-LED60	72.6"
RD-L8-1X8-LED80	95.6"

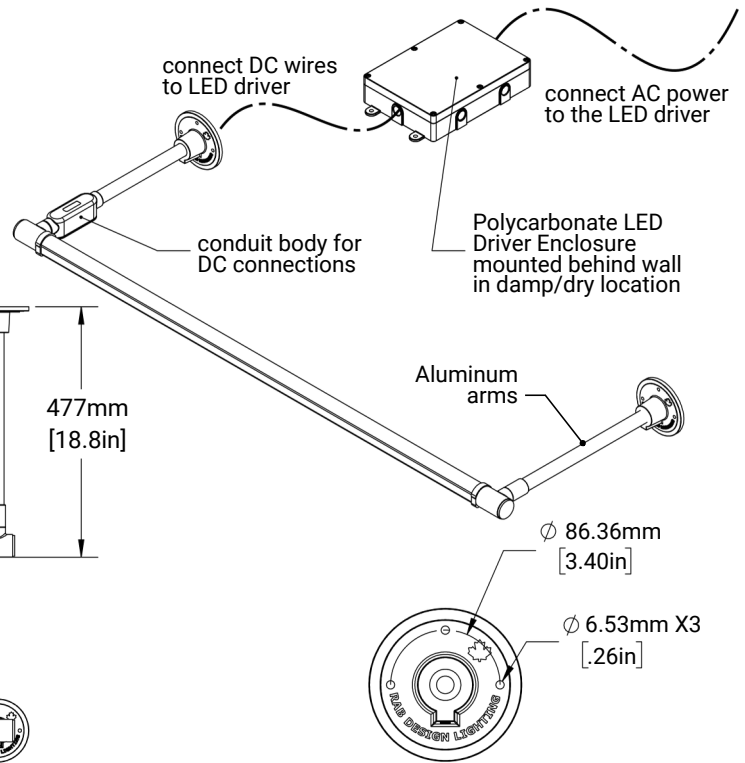
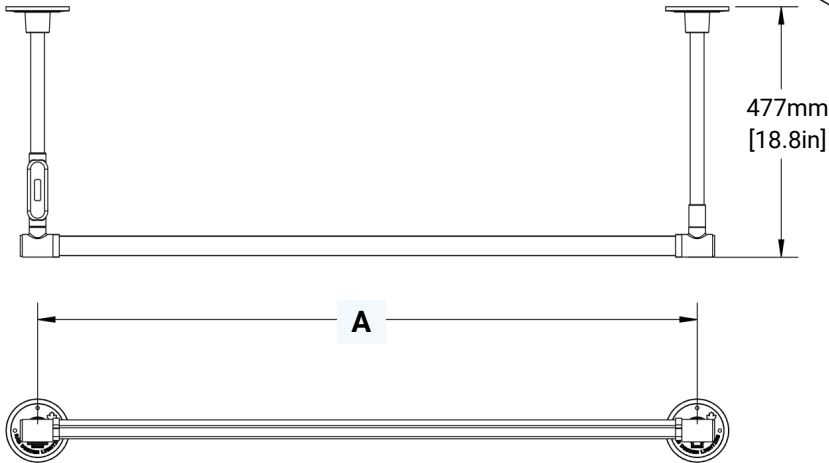

Dual Wall Mount:

RD-L8 CONFIGURATION	A	B
RD-L8-2X2-LED40	26.5"	26.5"
RD-L8-2X4-LED80	49.5"	49.5"
RD-L8-2X6-LED120	72.6"	72.6"
RD-L8-2X8-LED160	95.6"	95.6"
RD-L8-2+4-LED60	26.5"	49.5"
RD-L8-2+6-LED80	26.5"	72.6"
RD-L8-2+8-LED100	26.5"	95.6"
RD-L8-4+6-LED100	49.5"	72.6"
RD-L8-4+8-LED120	49.5"	95.6"
RD-L8-6+8-LED140	72.6"	95.6"

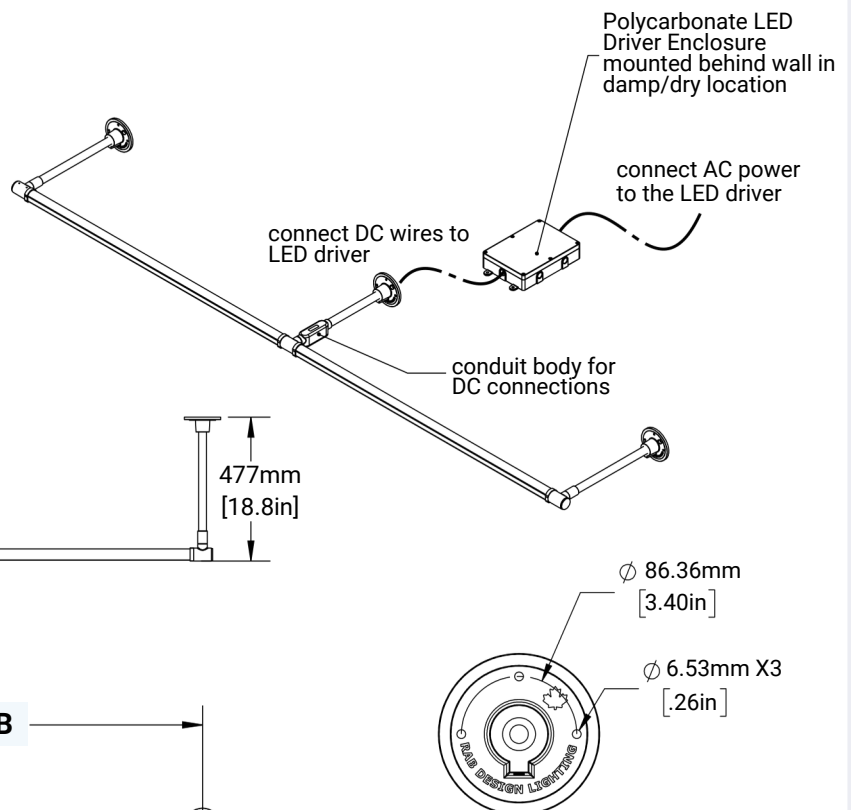
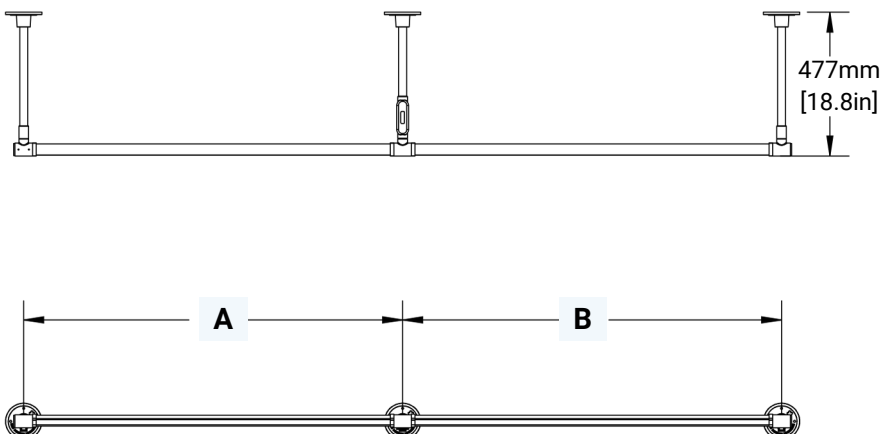

Wall Mount LED Driver Enclosure:

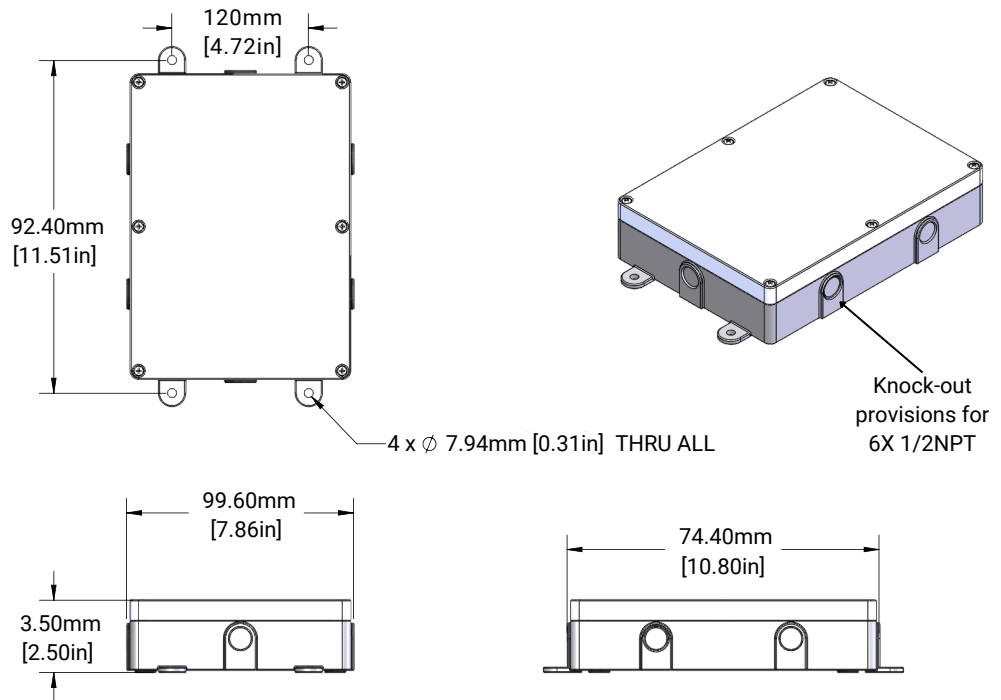

Single Parapet Mount:

RD-L8 CONFIGURATION	A
RD-L8-1X2-LED20-PPET	26.5"
RD-L8-1X4-LED40-PPET	49.5"
RD-L8-1X6-LED60-PPET	72.6"
RD-L8-1X8-LED80-PPET	95.6"

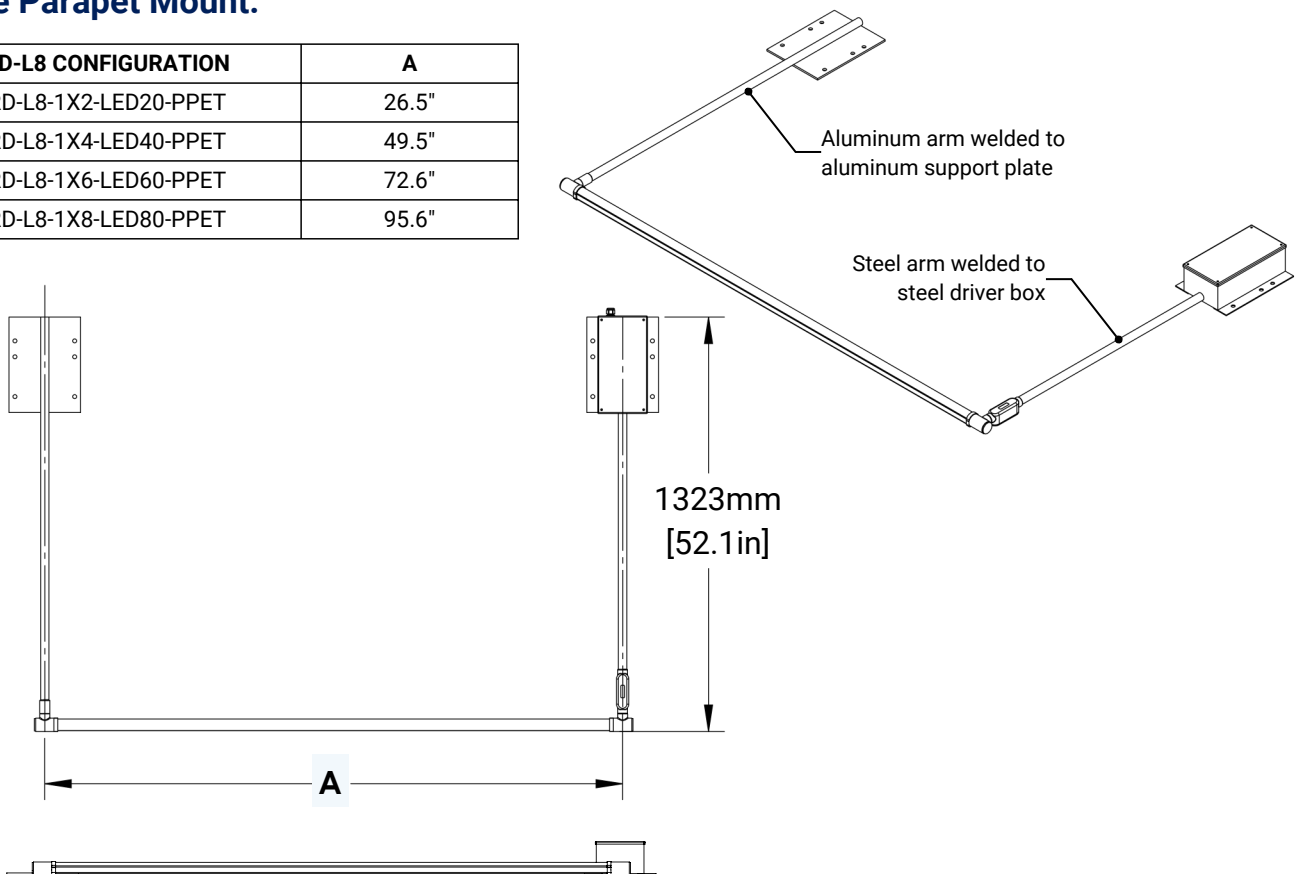

Dual Parapet Mount:

RD-L8 CONFIGURATION	A	B
RD-L8-2X2-LED40-PPET	26.5"	26.5"
RD-L8-2X4-LED80-PPET	49.5"	49.5"
RD-L8-2X6-LED120-PPET	72.6"	72.6"
RD-L8-2X8-LED160-PPET	95.6"	95.6"
RD-L8-2+4-LED60-PPET	26.5"	49.5"
RD-L8-2+6-LED80-PPET	26.5"	72.6"
RD-L8-2+8-LED100-PPET	26.5"	95.6"
RD-L8-4+6-LED100-PPET	49.5"	72.6"
RD-L8-4+8-LED120-PPET	49.5"	95.6"
RD-L8-6+8-LED140-PPET	72.6"	95.6"

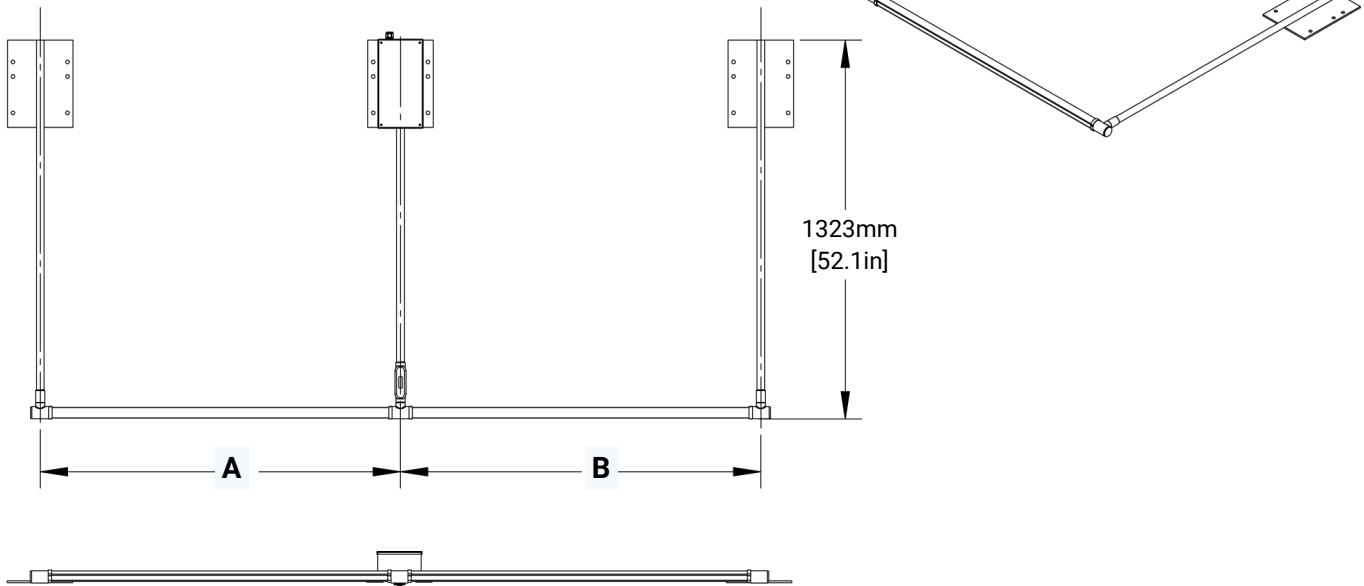

Parapet LED Driver Enclosure: (Steel)

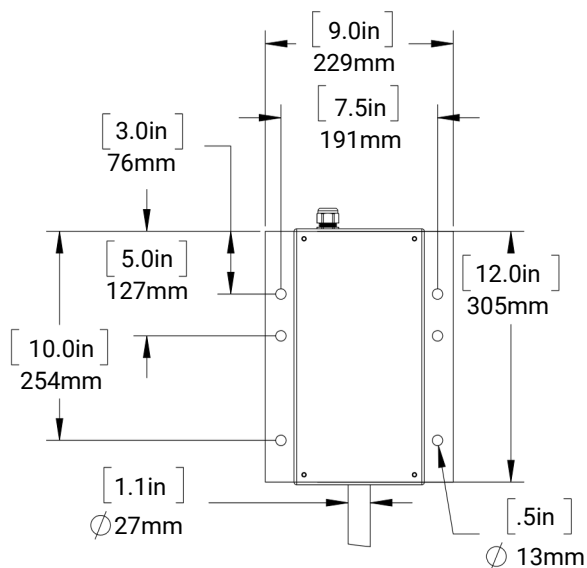

Parapet Roof Mount: (Aluminum)

