

## INSTALLATION INSTRUCTIONS



**ELECTRICAL SHOCK HAZARD**

**READ, UNDERSTAND, and FOLLOW** these instructions before installing the equipment.

## SAFETY

- Product should be mounted in locations where unauthorized personnel will not readily subject it to tampering.
- Do not use this equipment for anything other than its intended purpose.
- Servicing this equipment should be performed by qualified service personnel.
- Save these instructions for future reference.

## TOOLS REQUIRED

- Phillips Screwdriver
- Flathead Screwdriver
- Drill Tool (Optional)

## ELECTRICAL RATINGS

- Input Voltage: 3VDC
- Battery: 1x CR2032 (included)

## INSTALLATION & COMMISSIONING

### Step 1) Activate Battery

1. Remove pull tab from the remote control

### Step 2) Installation

#### Option 1: Handheld Remote

1. Use as a portable handheld remote control.

#### Option 2: Junction Box/Retrofit Mount

1. Remove the existing wall switch and wiring (if applicable).
2. Install the provided junction box bracket onto the junction box with supplied screws.
3. Slide the handheld remote into the switch holder. [2.1]
4. Install a wall plate (not included).

#### Option 3: Direct Wall Mount

1. Snap Part A off of the provided wall mount bracket. [2.2]
2. Install the wall mount bracket on the wall with provided screws. [2.3]
3. Slide the handheld remote into the bracket. [2.4]
4. Snap on the provided wall plate. [2.5]

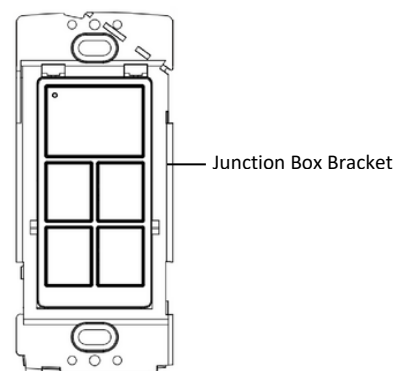

2.1

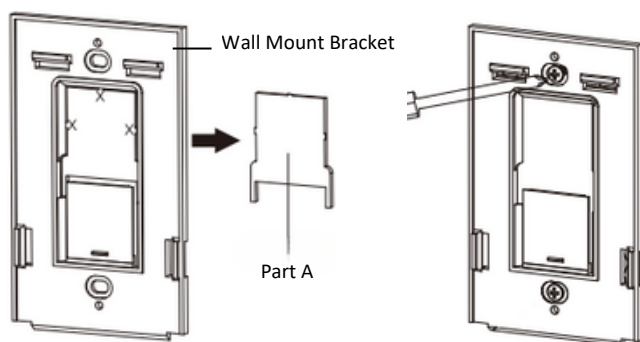

2.2

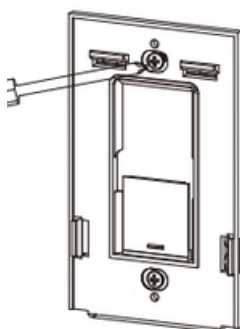

2.3

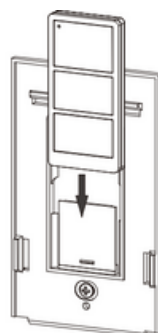

2.4

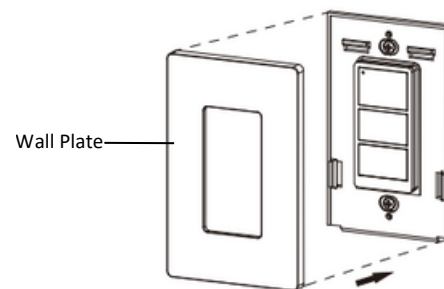

2.5

## INSTALLATION INSTRUCTIONS

### Step 3) Commissioning

1. Download the ControlLED APP using the QR codes. [3.1]
2. Ensure ControlLED enabled lights are added in the APP.
3. Press the switch buttons AUTO and DIM UP [3.3] together for over 3 seconds to enter into pairing mode.
4. Within the next 30 seconds, on the ControlLED App, on the “Switches” page, click to add the switch.
5. Select the light or group of lights to be Controlled by the switch.
6. Optional: Set up to 3 scenes using the App. Once set, press the Scene button once at a time to switch between scenes.

For more information on switch specifications and commissioning, please refer to the QR code. [3.2]

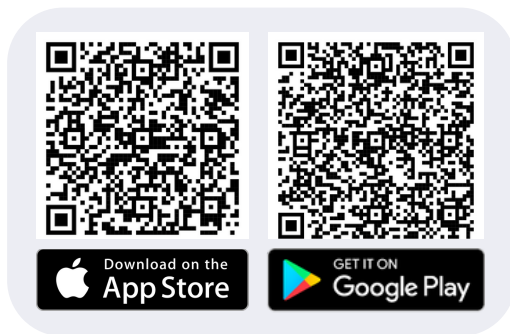

3.1

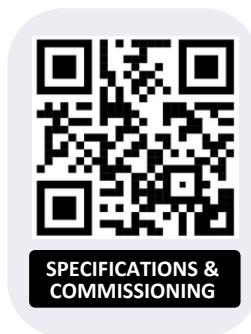

3.2

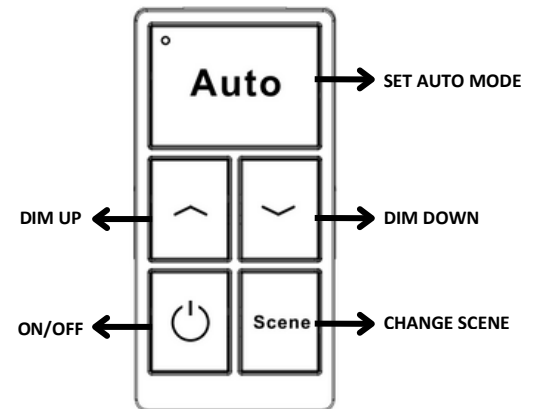

3.3

### Step 4) Battery Replacement

In the event that the remote runs out of power, do the following:

1. Pry the handheld remote cover open with a flathead screwdriver. [4.1]
2. Replace old battery with a new CR2032 battery. [4.2]
3. Reattach cover. [4.3]

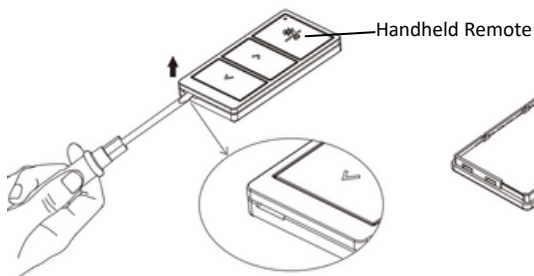

4.1

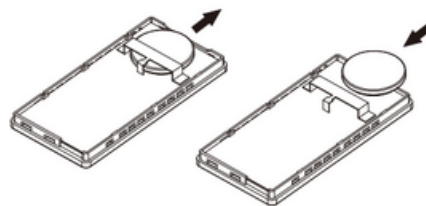

4.2

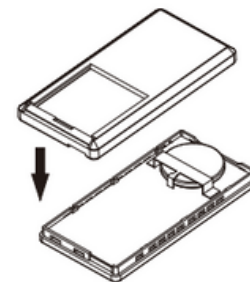

4.3