



D-CO MAXI LED INGROUND BY THORN

The D-CO Maxi LED inground has six 1.2 watt LEDs on an adjustable gimbal that can tilt up to 24°. The LEDs are available in blue or white with the option of 3000K or 4000K. The trim is made of stainless steel with a clear tempered glass lens. Each unit can withstand up to 500kg. The D-CO MAXI is ideal for use in landscape designs, illuminating statues, highlighting columns and for highlighting architectural detail. For a smaller version please see D-CO MID.

TRIM Stainless steel.

GLASS Clear tempered glass.

LEDs Six 1.2 watt LEDs. Available with blue or white LEDs that are available in 3000k and 4000k. Each unit is sealed with an integral driver and comes with 5 metres of wire that can be run to a central wiring compartment.

BODY Aluminum.

POUR HOUSING Made of ABS plastic.

IP67 / 500kg



Catalog Code

D-CO MAXI

LEDs

BLU - BLUE,
W3K - WHITE 3000K,
W4K - WHITE 4000K

RAB
DESIGN

DIMENSIONS

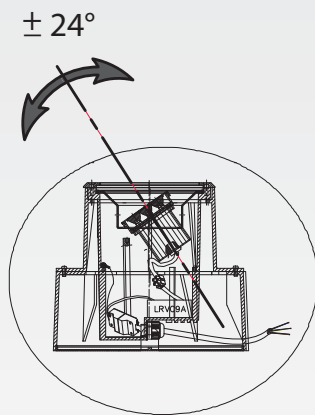

SIDE PROFILE SHOWING THE
MAXIMUM DEGREES OF TILT

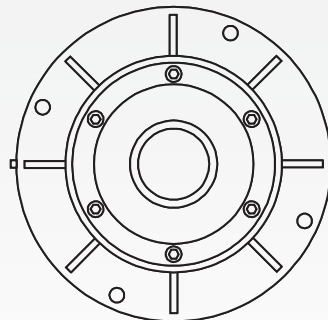
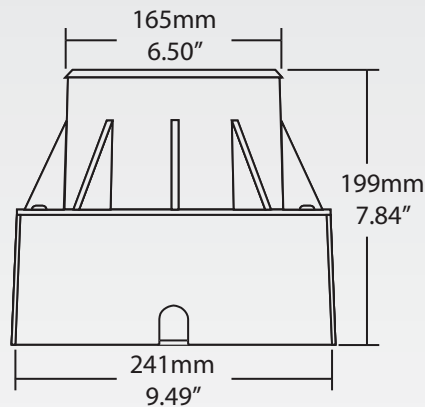

0511

www.rabdesign.ca