



# CCM-LED120

## COACHMAN SERIES

Post Top LED Area Light



### SPECIFICATIONS

|                           |  |
|---------------------------|--|
| Watts                     | 113.33   |
| Lumens                    | 10752  |
| Efficacy                  | 94.87  |
| Replaces Up To            | 400W MH  |
| Color Temp                | 3K, 4K*, 5K                                    |
| Operating Temp            | -40°C to 40°C                                  |
| Voltage                   | 120-277V*, 480V                                |
| LED Life                  | 100,000 hours                                  |
| Housing Material          | Die Cast Aluminum                              |
| Lens Material             | Polycarbonate                                  |
| Total Harmonic Distortion | 9.11   |
| Power Factor              | 0.983  |
| Mounting Options          | Post Top Mount, Wall Mount with decorative arm |
| Finish                    | Sandtex Black, Custom Colors                   |
| Beam Pattern              | T5*, T2**                                      |

\* Standard configuration

\*\*Note: CCM-LED120 is DLC approved in only the T5 beam pattern. Refer to page 4 for DLC listed configurations.



## DESCRIPTION

Ideal for pathway and area lighting applications, the Coachman LED is the new improved energy efficient version of the original lantern style HID fixture.

## APPLICATIONS



Office Complexes



Campuses



Parks



Townhouses



Walkways

## FEATURES

- Available in 3 wattages - 41W, 83W and 113W
- Cast aluminum housing with clear lens.
- Post top mount to fit a 3 inch diameter tenon.
- Decorative wall mount bracket available as an accessory.
- Traditional lantern style design.
- 90° or 180° house side cut off shield options available.
- Pole options include DPP4 and SPR.

## DIMENSIONS

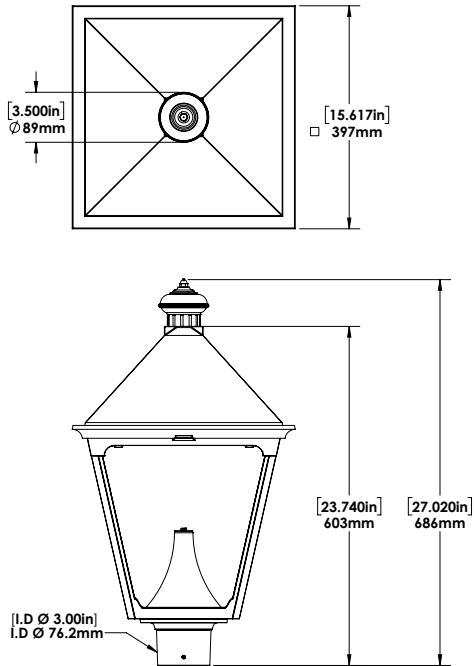

**With Decorative Top (Standard)**

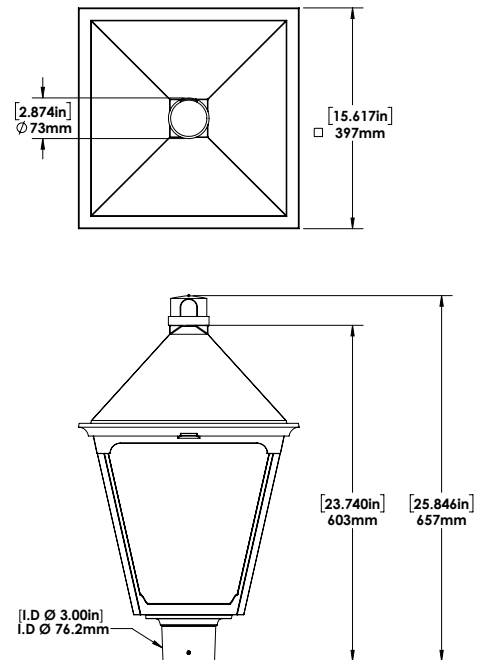

**With Photocell (Option)**



**DECORATIVE ARM 3\"/>**

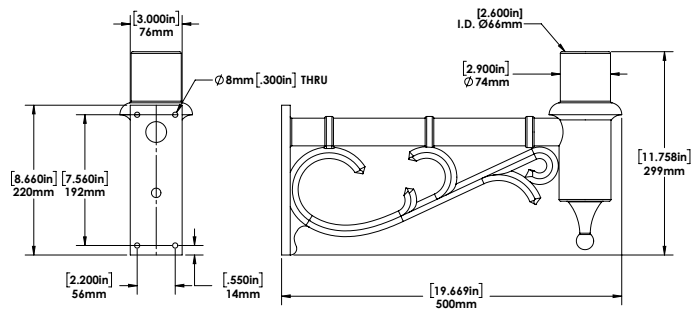

## HOUSE SIDE CUT OFF SHIELD

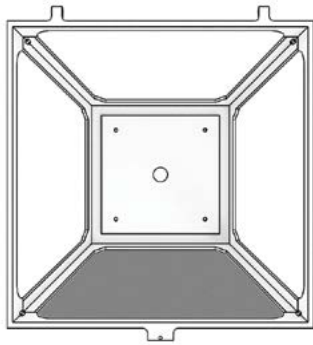

**C90**

90° House Side  
Cut-off shield

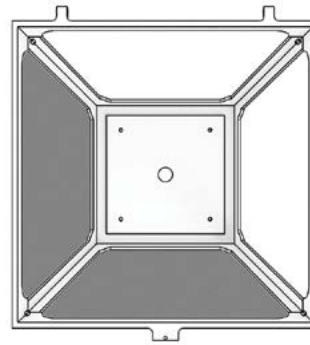

**C180**

180° House Side  
Cut-off shield

## POLE OPTIONS



**8' to 14'**

**DPP4**



**8' to 16'**

**SPR**

# SPECIFICATIONS

| MODEL DESCRIPTION          | VOLTAGE (V) | INPUT POWER (W) | LIGHT OUTPUT | EFFICACY (Lm/W) | THD   | PF    | CCT(K) | CRI   |
|----------------------------|-------------|-----------------|--------------|-----------------|-------|-------|--------|-------|
| CCM-LED120-B-3K-T5-XXX-DIM | 120-277     | 113.33          | 10737.48     | 94.74           | 9.11  | 0.983 | 3041   | 72.92 |
| CCM-LED120-B-4K-T5-XXX-DIM | 120-277     | 113.33          | 10752.39     | 94.87           | 9.11  | 0.983 | 3956.5 | 73.56 |
| CCM-LED120-B-5K-T5-XXX-DIM | 120-277     | 113.33          | 10767.31     | 95.00           | 9.11  | 0.983 | 4872   | 74.2  |
| CCM-LED120-L-3K-T5-XXX-DIM | 480         | 114.17          | 10747        | 94.1            | 10.41 | 0.991 | 3041   | 72.92 |
| CCM-LED120-L-4K-T5-XXX-DIM | 480         | 114.17          | 10758.31     | 94.23           | 10.41 | 0.991 | 3956.5 | 73.56 |
| CCM-LED120-L-5K-T5-XXX-DIM | 480         | 114.17          | 10773.23     | 94.36           | 10.41 | 0.991 | 4872   | 74.2  |

## Legend

B - 120-277V, L - 480V  
 3K - 3000K, 4K - 4000K, 5K - 5000K  
 T5 - Type V  
 XXX - Finish  
 DIM - Dimmable

# ORDERING GUIDE

| CCM    |       |                             |   |                              |   |                        |                |  |
|--------|-------|-----------------------------|---|------------------------------|---|------------------------|----------------|--|
|        | WATTS | VOLTAGE                     | COLOR TEMP.                             | BEAM PATTERN                 | FINISH  | DIMMING                | CONTROLS       | OPTIONS  |
| LED120 |       | B - 120 - 277V*<br>L - 480V | 3K - 3000K<br>4K - 4000K*<br>5K - 5000K | T5 - TYPE V*<br>T2 - TYPE II | SBK - SANDTEX BLACK*<br><br>CC - CUSTOM COLOR | DIM - 0 - 10V DIMMING* | PC - Photocell | C90 - 90° House Side Cut-off shield<br><br>C180 - 180° House Side Cut-off shield |

\* Standard configuration  
 \*\* Configurations with T2 beam pattern are not DLC listed.

FR - Frosted Lens

# FIELD INSTALLED ACCESSORIES

CHECK THE ACCESSORIES YOU WISH TO ORDER:

096801 DECORATIVE ARM 3”R BLACK