



# CCM-LED40

## COACHMAN SERIES

Post Top LED Area Light



### SPECIFICATIONS

Watts	40.52
Lumens	4382
Efficacy	108
Replaces Up To	150W MH
Color Temp	3K, 4K*, 5K
Operating Temp	-40°C to 40°C
Voltage	120-277V*, 480V
LED Life	100,000 hours
Housing Material	Die Cast Aluminum
Lens Material	Polycarbonate
Total Harmonic Distortion	9.11
Power Factor	0.983
Mounting Options	Post Top Mount, Wall Mount with decorative arm
Finish	Sandtex Black, Custom Colors
Beam Pattern	T5°, T2

\* Standard configuration



## DESCRIPTION

Ideal for pathway and area lighting applications, the Coachman LED is the new improved energy efficient version of the original lantern style HID fixture.

## APPLICATIONS



Office  
Complexes



Campuses



Parks



Townhouses



Walkways

## FEATURES

- Available in 3 wattages - 41W, 83W and 113W
- Cast aluminum housing with clear lens.
- Post top mount to fit a 3 inch diameter tenon.
- Decorative wall mount bracket available as an accessory.
- Traditional lantern style design.
- 90° or 180° house side cut off shield options available.
- Pole options include DPP4 and SPR.

## DIMENSIONS

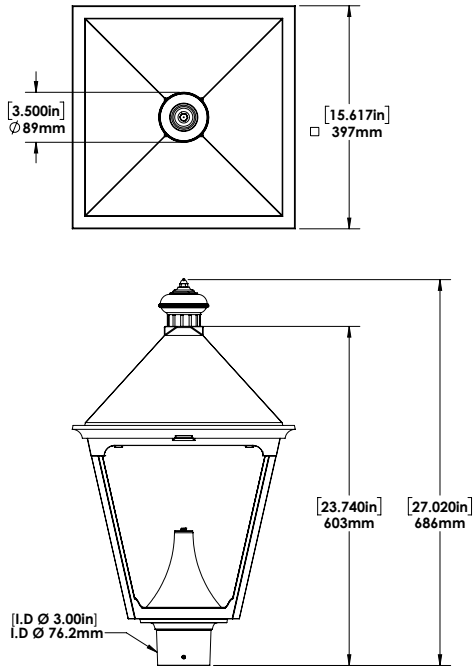

**With Decorative Top (Standard)**

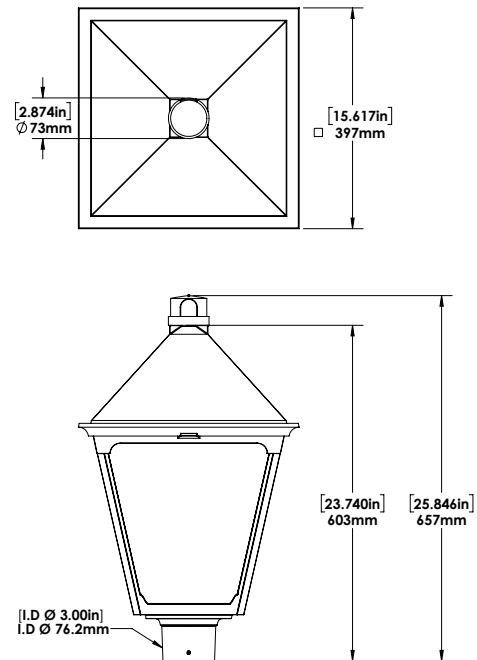

**With Photocell (Option)**



**DECORATIVE ARM 3\"/>**

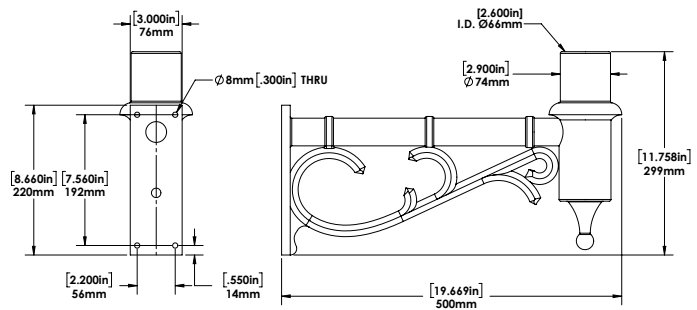

## HOUSE SIDE CUT OFF SHIELD

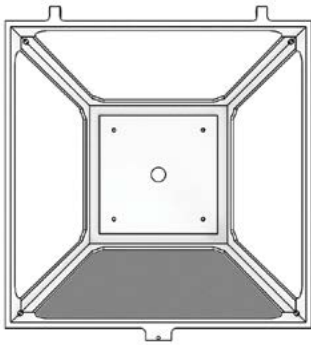

**C90**

90° House Side  
Cut-off shield

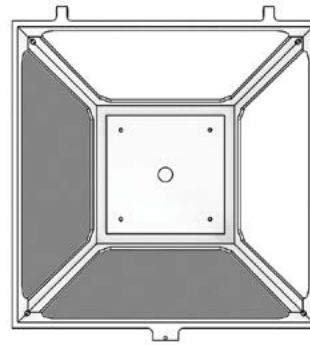

**C180**

180° House Side  
Cut-off shield

## POLE OPTIONS



**8' to 14'**

**DPP4**



**8' to 16'**

**SPR**

SPECIFICATIONS

MODEL DESCRIPTION	VOLTAGE (V)	INPUT POWER (W)	LIGHT OUTPUT	EFFICACY (Lm/W)	THD	PF	CCT(K)	CRI
CCM-LED40-B-3K-T5-XXX-DIM	120-277	40.59	4385	108	9.11	0.983	3041	72.92
CCM-LED40-B-4K-T5-XXX-DIM	120-277	40.52	4382.23	108.15	9.11	0.983	3956.5	73.56
CCM-LED40-B-5K-T5-XXX-DIM	120-277	40.45	4379	108.3	9.11	0.983	4872	74.2
CCM-LED40-B-3K-T2-XXX-DIM	120-277	40.41	4160	102.9	9.11	0.983	3041	72.92
CCM-LED40-B-4K-T2-XXX-DIM	120-277	40.52	4175.29	103.04	9.11	0.983	3956.5	74
CCM-LED40-B-5K-T2-XXX-DIM	120-277	40.52	4181.08	103.18	9.11	0.983	4872	74.2
CCM-LED40-L-3K-T5-XXX-DIM	480	40.82	4378.56	107.26	9.11	0.983	3041	72.92
CCM-LED40-L-4K-T5-XXX-DIM	480	40.82	4384.65	107.41	9.11	0.983	3956.5	
CCM-LED40-L-5K-T5-XXX-DIM	480	40.82	4390.73	107.56	9.11	0.983	4872	74.2
CCM-LED40-L-3K-T2-XXX-DIM	480	40.82	4170	102.2	12.02	0.9679	3041	72.92
CCM-LED40-L-4K-T2-XXX-DIM	480	40.82	4177.59	102.34	12.02	0.9679	3956.5	73.56
CCM-LED40-L-5K-T2-XXX-DIM	480	40.82	4183.39	102.48	12.02	0.9679	4872	74.2

**Legend**  
B - 120-277V, L -480  
3K - 3000K, 4K - 4000K, 5K - 5000K  
T2 - Type 2, T5 - Type V  
XXX - Finish  
DIM - Dimmable

ORDERING GUIDE

CCM								
	WATTS	VOLTAGE	COLOR TEMP.	BEAM PATTERN	FINISH	DIMMING	CONTROLS	OPTIONS
	LED40	B - 120 - 277V* L - 480	3K - 3000K 4K - 4000K* 5K- 5000K	T5 - TYPE V* T2 - TYPE II	SBK - SANDTEX BLACK*  CC - CUSTOM COLOR	DIM - 0 - 10V DIMMING*	PC - Photocell	C90 - 90° House Side Cut-off shield  C180 - 180° House Side Cut-off shield

\* Standard configuration

FR - Frosted Lens

FIELD INSTALLED ACCESSORIES

CHECK THE ACCESSORIES YOU WISH TO ORDER:

096801 DECORATIVE ARM 3”R BLACK