

The WRD4 is an architectural, specification grade down light with advanced optics available in custom color finishes.



### APPLICATIONS

**Ideal for perimeter lighting in retail buildings, atriums, condominiums and other architectural properties.**

<b>Project</b>	
<b>Type</b>	
<b>Date</b>	
<b>Notes</b>	

### SPECIFICATIONS

#### Construction

WRD4 has an extruded aluminum housing with a powder coat paint finish. The fixture has a clear tempered glass lens which is held in place with a gasket and three stainless steel screws making it approved for wet locations.

#### Mounting

The fixture can be mounted directly on to the wall with a recessed junction box and has an easy mounting system. The galvanized steel plate is attached to the wall with 4 screws. The fixture then slides under the two pins and is secured by the two set screws at the bottom.

#### Optics

The fixture has a standard color temperature of 5000K, 4000K and 3000K are available as options. The fixture also has optional diffusion lenses for narrow, medium, wide or extra wide beams.

#### Electrical

The standard unit has a high efficiency driver that operates at 120-277V.

#### Finish

Standard finish is black, bronze and white. Custom colors available.

<b>Diameter</b>	<b>4.7"</b>
<b>Watts</b>	<b>14W</b>
<b>Lumens</b>	<b>1337</b>
<b>Efficiency</b>	<b>97 lumens/watt</b>

<b>Operating Temp</b>	<b>-40°C to +40°C</b>
<b>LED Life</b>	<b>100,000 hours</b>
<b>Color Temp.</b>	<b>5000K (standard), 4000K, 3000K (option)</b>
<b>Warranty</b>	<b>5 Years</b>
<b>Certification</b>	<b>Approved to uL/CSA standards</b>

### DIMENSIONS

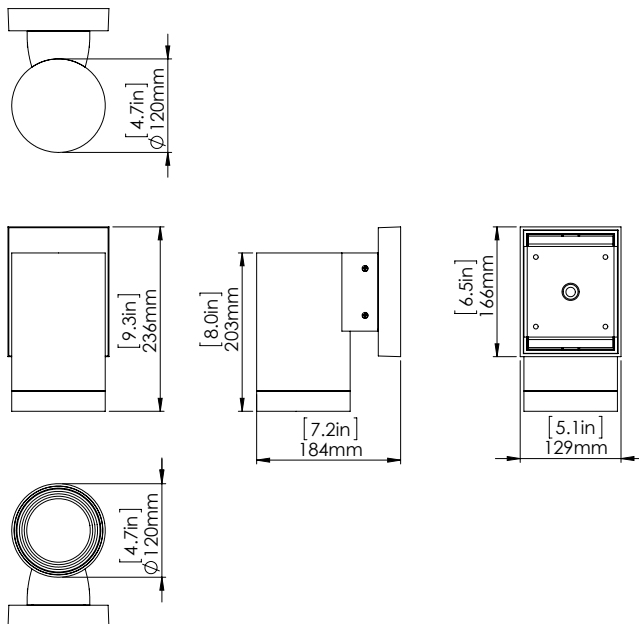

## EASY INSTALLATION

Step 1: Attach steel plate on the wall with 4 screws



Step 2: Slide fixture under the two pins till it locks in



Step 3: Secure with 2 set screws on the bottom



## ORDERING GUIDE

<b>WRD4</b>	-	<b>LED15</b>	-		-		-	
		VOLTAGE			COLOR TEMP.			OPTICS
		<b>B - 120 - 277V</b>			<b>3K - 3000K</b>			<b>N - NARROW</b>
					<b>4K - 4000K</b>			<b>M - MEDIUM</b>
					<b>5K - 5000K</b>			<b>W - WIDE</b>
								<b>X - EXTRA WIDE</b>
								FINISH
								<b>WH - WHITE</b>
								<b>BLK - BLACK</b>
								<b>BRZ - BRONZE</b>
								<b>CC - CUSTOM COLOR</b>

\* Standard configuration