

## INSTALLATION INSTRUCTIONS



### ELECTRICAL SHOCK HAZARD

**READ, UNDERSTAND, and FOLLOW** these instructions before installing the equipment.

## WARNING

Disconnect the Electrical supply power at the service panel (fuse or circuit breaker box). Failure to do so could result in serious injury or death. Only qualified electricians should install this fixture and the installation **MUST** conform to the Electrical Code and all local codes and ordinances. Ensure that only proper tools, materials, and equipment are used to complete the installation.

## SAFETY

- Proper grounding is required to ensure personal safety.
- Fixture should be mounted in locations where unauthorized personnel will not readily subject it to tampering.
- Do not use this equipment for anything other than its intended purpose.
- Servicing this equipment should be performed by qualified service personnel.
- Save these instructions.

## INSTALLATION

### RECESSED CEILING MOUNT

- Make appropriate wiring connections as per the wiring diagram
- Push fixture up through open ceiling grid
- Rotate the fixture in the proper orientation by aligning it with the ceiling grid
- Gently lower fixture to rest on the T bar ceiling

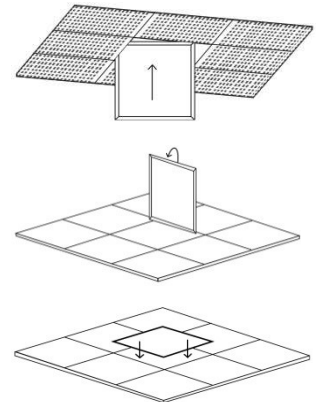

### PENDANT MOUNT

- Put the ball end of the steel wire through the hole of the panel Bracket
- Put the other end of the steel wire through the wire holder
- Mount anchor bolts into ceiling
- Hang the 4 wire holders to the anchor bolts, adjust the wire lengths and secure with screws

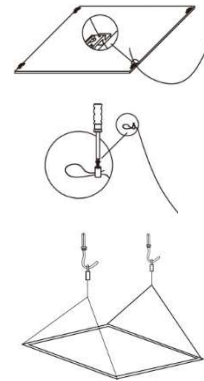

## WIRING

- Check that the line voltage is correct.
- Connect fixture **GROUND** (green) wire to power supply **GROUND** (green) wire.
- Connect fixture **WHITE** wire to power supply **NEUTRAL** wire.
- Connect fixture **BLACK** wire to power supply **LINE** wire
- If the fixture includes 0-10V dimming functionality, connect **GREY** and **VIOLET** wires to the dimming controller.

