



# LIGHTING SCIENCES CANADA LTD.

160 Frobisher Drive, Unit 5, Waterloo, Ontario, Canada N2V 2B1  
Tel: (519) 746-3140 Fax: (519) 746-3156 lsc@lightingsciences.ca

CERTIFIED TEST REPORT NO. LSC F382

RAB DESIGN WALL MOUNTED CFL FIXTURE CAT. NO. WL-R-42CFL-120  
WITH SEMI-SPECULAR REFLECTOR AND PRISMATIC REFRACTOR  
ONE 42W TRIPLE-TUBE COMPACT FLUORESCENT LAMP. LUMEN RATING = 3200 LMS.  
ANTRON ELECTRONICS 120-277V 1 OR 2-LAMP ELECTRONIC BALLAST NO. CSS-UV42PBMS

BUG RATING: B 0 U 3 G 2

REPORT PREPARED FOR:

RAB DESIGN LIGHTING INC.  
TORONTO, ONTARIO

CERTIFIED BY:

*Charles Lison*

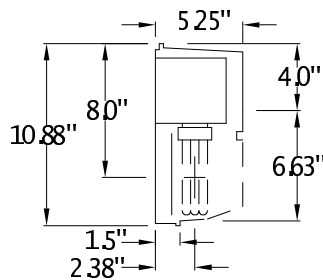

DATE: DEC 9, 2011

LABORATORY RESULTS MAY NOT BE REPRESENTATIVE OF FIELD PERFORMANCE.  
BALLAST FACTORS HAVE NOT BEEN APPLIED.

TESTED IN 30 PLANES LEFT SIDE, 30 PLANES RIGHT SIDE, LEFT AND RIGHT AVERAGED

VERTICAL TEST INCREMENTS ARE 2.5 DEGREES.

TEST DISTANCE EXCEEDS FIVE TIMES THE GREATEST  
LUMINOUS OPENING OF LUMINAIRE.

TESTED IN ACCORDANCE WITH IES RECOMMENDED PROCEDURES

# LIGHTING SCIENCES CANADA LTD.

160 FROBISHER DRIVE, UNIT 5  
WATERLOO, ONTARIO

## TEST REPORT NO. F382

RAB DESIGN WALL MOUNTED CFL FIXTURE CAT. NO. WL-R-42CFL-120  
WITH SEMI-SPECULAR REFLECTOR AND PRISMATIC REFRACTOR  
ONE 42W TRIPLE-TUBE COMPACT FLUORESCENT LAMP. LUMEN RATING = 3200 LMS.  
ANTRON ELECTRONICS 120-277V 1 OR 2-LAMP ELECTRONIC BALLAST NO. CSS-UV42PBMS

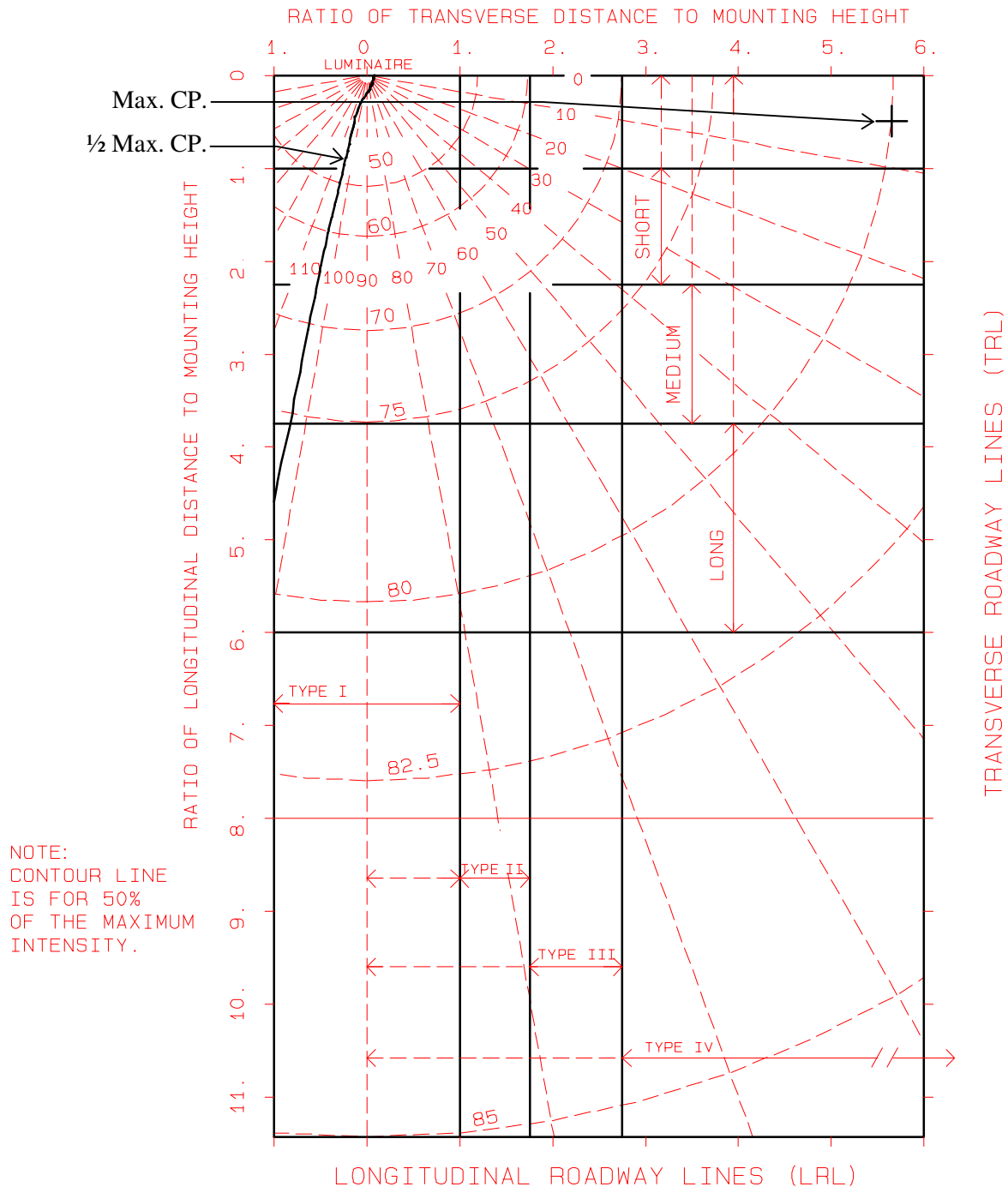

IES CLASSIFICATION: TYPE IV, VERY SHORT

LIGHTING SCIENCES CANADA LTD.  
160 FROBISHER DRIVE, UNIT 5  
WATERLOO, ONTARIO

CERTIFIED TEST REPORT NO. LSC F382

RAB DESIGN WALL MOUNTED CFL FIXTURE CAT. NO. WL-R-42CFL-120  
WITH SEMI-SPECULAR REFLECTOR AND PRISMATIC REFRACTOR  
ONE 42W TRIPLE-TUBE COMPACT FLUORESCENT LAMP. LUMEN RATING = 3200 LMS.  
ANTRON ELECTRONICS 120-277V 1 OR 2-LAMP ELECTRONIC BALLAST NO. CSS-UV42PBMS

UTILIZATION TABLE

CO-EFFICIENT OF UTILIZATION

RATIO	HOUSE SIDE	STREET SIDE	TOTAL
.5	.039	.053	.093
1.0	.058	.099	.157
1.5	.065	.129	.195
2.0	.069	.150	.219
2.5	.071	.164	.235
3.0	.072	.173	.245
3.5	.072	.182	.254
4.0	.073	.186	.259
5.0	.074	.194	.268
TOTAL:	.076	.227	.303

PERCENTAGE OUTPUTS

DOWNWARD:	STREET SIDE	=	22.7%
	HOUSE SIDE	=	7.6%
	TOTAL	=	30.3%
UPWARD:	STREET SIDE	=	14.0%
	HOUSE SIDE	=	2.9%
	TOTAL	=	16.9%
TOTAL EFFICIENCY		=	47.2%

CERTIFIED TEST REPORT NO. LSC F382

CANDLEPOWER  
IN MAX. PLANE

ANGLE	CANDLEPOWER
.0	129
5.0	143
10.0	160
15.0	178
20.0	197
25.0	212
30.0	221
35.0	229
40.0	237
45.0	246
50.0	254
52.5	258
55.0	261
57.5	264
60.0	267
62.5	270
65.0	273
67.5	275
70.0	277
72.5	278
75.0	279
77.5	279
80.0	280
82.5	279
85.0	276
87.5	273
90.0	268
95.0	258
105.0	225
115.0	179
125.0	127
135.0	82
145.0	51
155.0	51
165.0	35
175.0	20
180.0	0

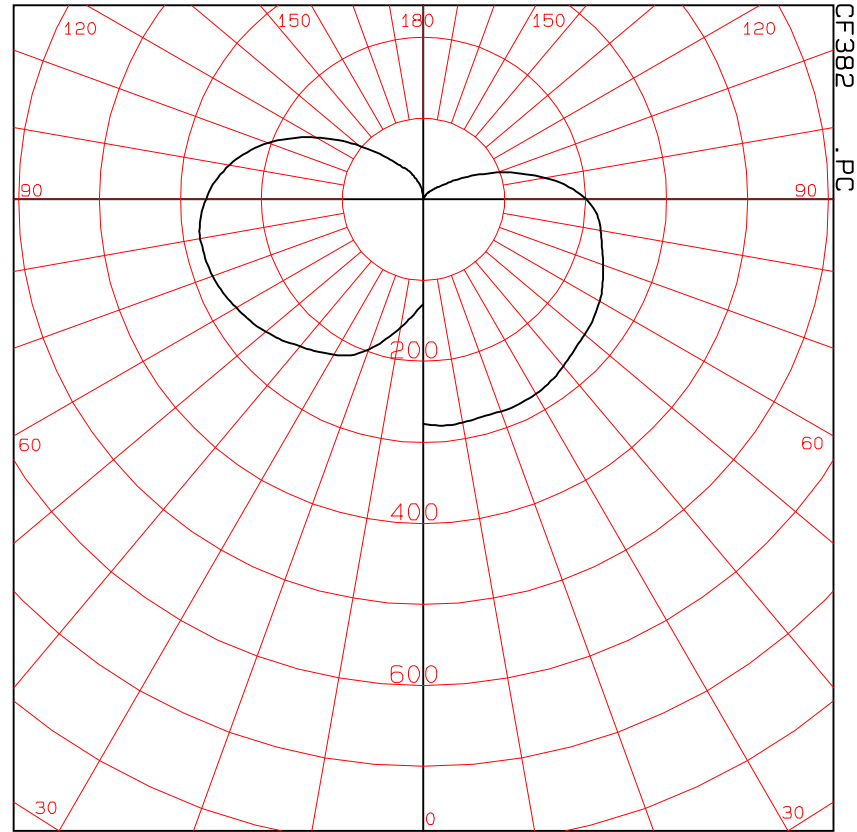

MAXIMUM CANDLEPOWER: 280  
PLANE OF MAXIMUM: 5.0  
VERTICAL ANGLE OF MAXIMUM: 80.0

CANDLEPOWER  
IN MAX. CONE

ANGLE	CANDLEPOWER
.0	277
5.0	280
15.0	278
25.0	279
35.0	274
45.0	263
55.0	256
60.0	251
62.5	248
65.0	244
67.5	240
70.0	236
72.5	232
75.0	228
77.5	225
80.0	222
82.5	219
85.0	215
87.5	209
90.0	201
95.0	180
105.0	124
115.0	71
125.0	34
135.0	18
145.0	10
155.0	5
165.0	2
175.0	0
180.0	0

CERTIFIED TEST REPORT NO. LSC F382

RAB DESIGN WALL MOUNTED CFL FIXTURE CAT. NO. WL-R-42CFL-120  
 WITH SEMI-SPECULAR REFLECTOR AND PRISMATIC REFRACTOR  
 ONE 42W TRIPLE-TUBE COMPACT FLUORESCENT LAMP. LUMEN RATING = 3200 LMS.  
 ANTRON ELECTRONICS 120-277V 1 OR 2-LAMP ELECTRONIC BALLAST NO. CSS-UV42PBMS

CANDLEPOWER SUMMARY

VERT. ANGLE	HORIZONTAL ANGLES - STREET SIDE									
	.0	5.0	15.0	25.0	35.0	45.0	55.0	65.0	75.0	85.0
		****								
.0	129	129	129	129	129	129	129	129	129	129
5.0	141	143	143	142	141	140	139	137	136	134
10.0	158	160	159	158	156	153	150	147	144	140
15.0	176	178	178	175	172	167	162	156	151	146
20.0	194	197	196	192	187	181	173	165	158	152
25.0	210	212	210	207	201	193	184	174	165	157
30.0	218	221	220	216	210	202	192	181	170	161
35.0	226	229	227	223	217	209	199	188	176	165
40.0	233	237	234	230	223	215	206	195	183	170
45.0	242	246	243	238	231	223	215	204	191	177
50.0	251	254	251	246	240	232	224	212	198	183
55.0	258	261	258	255	249	241	232	221	206	190
60.0	264	267	265	264	258	250	241	230	215	198
65.0	270	273	271	270	265	256	247	236	221	204
70.0	274	277	275	275	271	261	252	241	225	210
75.0	275	279	277	278	273	263	255	243	227	212
80.0**	277	280	278	279	274	263	256	244	228	215
85.0	276	276	274	275	271	259	252	241	226	214
90.0	269	268	266	267	262	251	246	236	222	212

HORIZONTAL ANGLES - HOUSE SIDE											
	90.0	95.0	105.0	115.0	125.0	135.0	145.0	155.0	165.0	175.0	180.0
.0	129	129	129	129	129	129	129	129	129	129	129
5.0	133	133	131	130	129	128	128	127	127	127	127
10.0	139	138	135	132	130	129	127	126	125	124	124
15.0	144	142	138	134	130	127	124	122	120	119	119
20.0	149	146	140	134	128	123	119	115	112	111	110
25.0	153	149	141	133	125	117	111	106	102	100	99
30.0	156	151	140	129	119	109	101	95	90	88	88
35.0	160	153	140	126	112	101	91	84	78	76	76
40.0	164	156	139	121	105	91	80	72	66	64	63
45.0	169	160	139	117	97	81	69	61	55	52	51
50.0	175	164	138	112	89	71	59	50	44	41	40
55.0	180	168	137	106	80	61	48	40	34	31	30
60.0	187	172	136	101	71	51	39	30	24	21	20
65.0	192	176	134	93	61	41	30	22	16	13	12
70.0	197	178	131	86	51	32	21	14	9	7	6
75.0	199	179	127	78	42	24	15	9	4	2	2
80.0**	201	180	124	71	34	18	10	5	2	0	0
85.0	200	179	121	65	29	15	8	4	1	0	0
90.0	199	178	119	63	28	15	8	4	1	0	0

\*\* DENOTES VERTICAL ANGLE OF MAXIMUM CONE

\*\*\*\* DENOTES LATERAL ANGLE OF MAXIMUM PLANE

CANDLEPOWER WAS MEASURED IN 2.5 DEGREE STEPS - TABULATIONS ARE AVAILABLE

# ISOFOOTCANDLE

TEST REPORT NO. F382

RAB DESIGN WALL MOUNTED CFL FIXTURE CAT. NO. WL-R-42CFL-120  
WITH SEMI-SPECULAR REFLECTOR AND PRISMATIC REFRACTOR  
ONE 42W TRIPLE-TUBE COMPACT FLUORESCENT LAMP. LUMEN RATING = 3200 LMS.  
ANTRON ELECTRONICS 120-277V 1 OR 2-LAMP ELECTRONIC BALLAST NO. CSS-UV42PBMS

MOUNTING HEIGHT FOR ISOFC 12.0 FEET

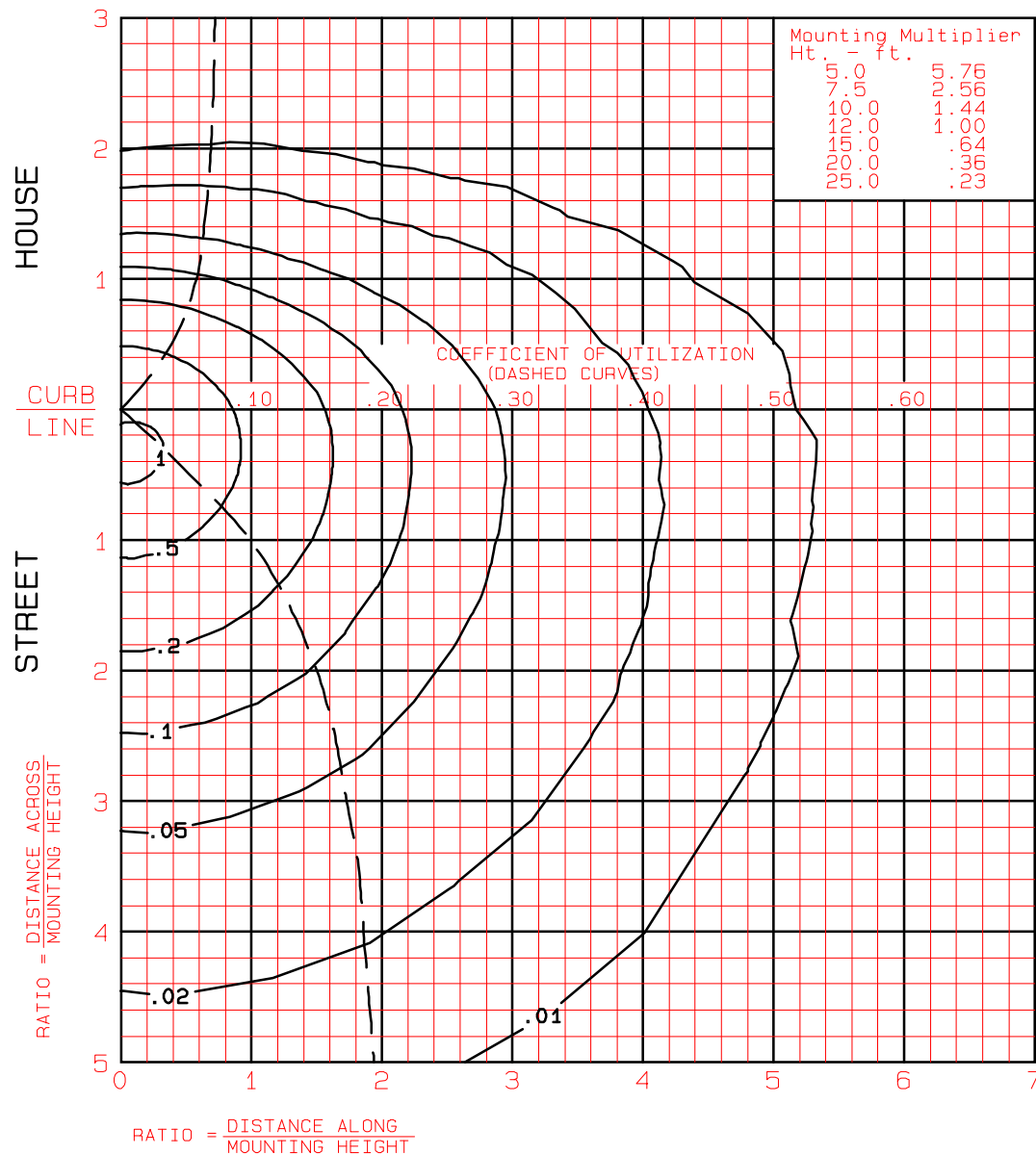

CERTIFIED TEST REPORT NO. LSC F382

\*\* FOOTCANDLE TABLE FOR SINGLE LUMINAIRE AT 12.0 FT. \*\*

LATERAL RATIOS															
-3.00	+	+	+	+	+	+	+	+	+	+	+	+	+	+	+
	.001	.001	.002	.002	.002	.002	.002	.002	.002	.002	.002	.002	.002	.001	.001
-2.50	+	+	+	+	+	+	+	+	+	+	+	+	+	+	+
	.003	.004	.004	.004	.004	.004	.003	.003	.003	.003	.002	.002	.002	.002	.002
-2.00	+	+	+	+	+	+	+	+	+	+	+	+	+	+	+
	.009	.010	.010	.010	.008	.007	.006	.006	.005	.004	.004	.003	.003	.002	.002
-1.50	+	+	+	+	+	+	+	+	+	+	+	+	+	+	+
	.033	.033	.029	.023	.018	.015	.012	.010	.008	.007	.005	.004	.004	.003	.003
-1.00	+	+	+	+	+	+	+	+	+	+	+	+	+	+	+
	.12	.11	.083	.058	.041	.030	.022	.016	.012	.009	.007	.006	.005	.004	.003
-.50	+	+	+	+	+	+	+	+	+	+	+	+	+	+	+
	.47	.38	.22	.13	.080	.050	.033	.023	.016	.012	.009	.007	.006	.004	.004
HOUSE															
-----	+	+	+	+	+	+	+	+	+	+	+	+	+	+	+
STREET	.90	.76	.41	.21	.11	.070	.044	.029	.020	.014	.011	.008	.006	.005	.004
.50	+	+	+	+	+	+	+	+	+	+	+	+	+	+	+
	1.0	.79	.43	.23	.12	.074	.046	.031	.021	.015	.011	.008	.007	.005	.004
1.00	+	+	+	+	+	+	+	+	+	+	+	+	+	+	+
	.59	.49	.32	.19	.11	.069	.044	.030	.021	.015	.011	.008	.007	.005	.004
1.50	+	+	+	+	+	+	+	+	+	+	+	+	+	+	+
	.30	.27	.20	.13	.090	.059	.040	.027	.019	.014	.011	.008	.006	.005	.004
2.00	+	+	+	+	+	+	+	+	+	+	+	+	+	+	+
	.16	.15	.12	.095	.067	.047	.034	.024	.018	.013	.010	.008	.006	.005	.004
2.50	+	+	+	+	+	+	+	+	+	+	+	+	+	+	+
	.097	.093	.081	.065	.050	.037	.027	.021	.016	.012	.009	.007	.006	.005	.004
3.00	+	+	+	+	+	+	+	+	+	+	+	+	+	+	+
	.060	.059	.053	.045	.036	.029	.022	.017	.013	.011	.008	.007	.005	.004	.004
3.50	+	+	+	+	+	+	+	+	+	+	+	+	+	+	+
	.040	.039	.036	.032	.027	.022	.018	.014	.011	.009	.008	.006	.005	.004	.003
4.00	+	+	+	+	+	+	+	+	+	+	+	+	+	+	+
	.027	.027	.025	.023	.020	.017	.014	.012	.010	.008	.007	.005	.005	.004	.003
4.50	+	+	+	+	+	+	+	+	+	+	+	+	+	+	+
	.020	.019	.018	.017	.015	.013	.011	.010	.008	.007	.006	.005	.004	.003	.003
5.00	+	+	+	+	+	+	+	+	+	+	+	+	+	+	+
	.014	.014	.014	.013	.012	.011	.009	.008	.007	.006	.005	.004	.004	.003	.003
	0.0	0.5	1.0	1.5	2.0	2.5	3.0	3.5	4.0	4.5	5.0	5.5	6.0	6.5	7.0
	LONGITUDINAL MOUNTING HEIGHT RATIOS														

CORRECTION FACTORS FOR OTHER MOUNTING HEIGHTS: SEE ISOFOOTCANDLE PAGE

LIGHTING SCIENCES CANADA LTD.  
160 FROBISHER DRIVE, UNIT 5  
WATERLOO, ONTARIO

CERTIFIED TEST REPORT NO. LSC F382

RAB DESIGN WALL MOUNTED CFL FIXTURE CAT. NO. WL-R-42CFL-120  
WITH SEMI-SPECULAR REFLECTOR AND PRISMATIC REFRACTOR  
ONE 42W TRIPLE-TUBE COMPACT FLUORESCENT LAMP. LUMEN RATING = 3200 LMS.  
ANTRON ELECTRONICS 120-277V 1 OR 2-LAMP ELECTRONIC BALLAST NO. CSS-UV42PBMS

IESNA TM-15-11 LUMINAIRE CLASSIFICATION SYSTEM  
EVALUATION

FORWARD LIGHT

Luminaire Lumens	726	
% Lamp Lumens	22.7%	
FL (0 - 30)	2.3%	( 74)
FM (30 - 60)	8.0%	( 254)
FH (60 - 80)	8.1%	( 260)
FVH (80 - 90)	4.3%	( 138)

BACK LIGHT

Luminaire Lumens	243	
% Lamp Lumens	7.6%	
BL (0 - 30)	1.6%	( 52)
BM (30 - 60)	3.3%	( 104)
BH (60 - 80)	1.9%	( 61)
BVH (80 - 90)	0.8%	( 26)

UPLIGHT

Luminaire Lumens	541	
% Lamp Lumens	16.9%	
UL (90 - 100)	4.9%	( 157)
UH (100 - 180)	12.0%	( 384)

TRAPPED LIGHT

Luminaire Lumens	1690	
% Lamp Lumens	52.8%	

BUG Rating

B 0  
U 3  
G 2